

# Suspended over water

Boston ICA: Elizabeth  
Diller and Ricardo  
Scofidio, 2006



The Blur Building, on Lake Neuchatel for Swiss Expo 2002, a structure that Architecture Magazine called "(an) inhabitable cloud whirling above a lake."





80 foot cantilever, 65,000 s.f.

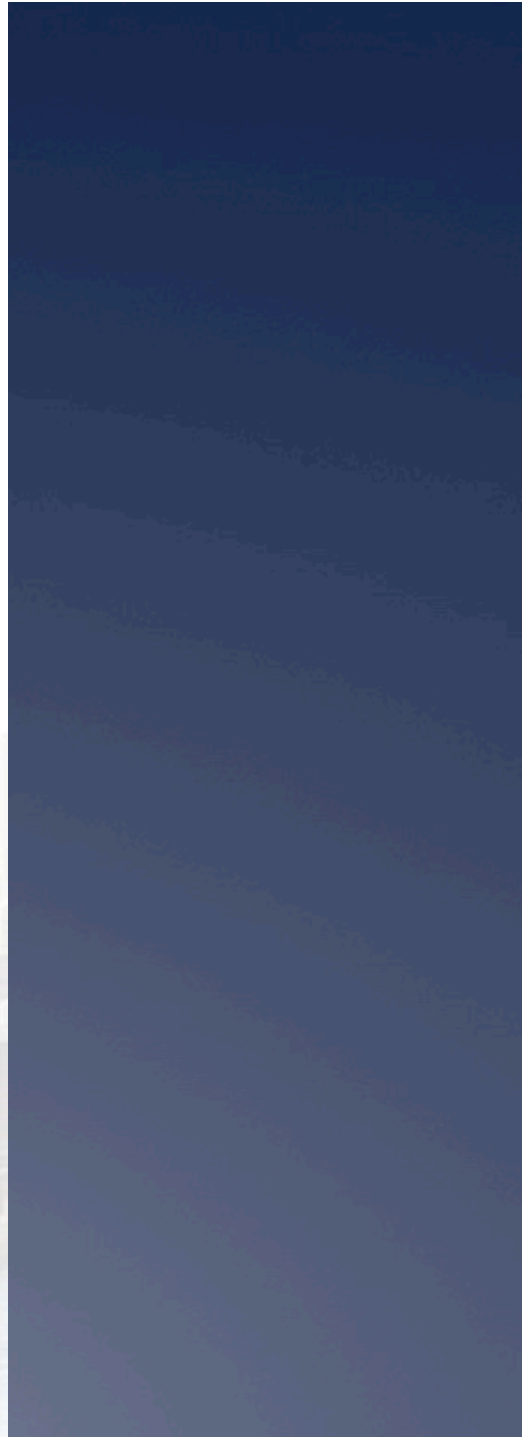
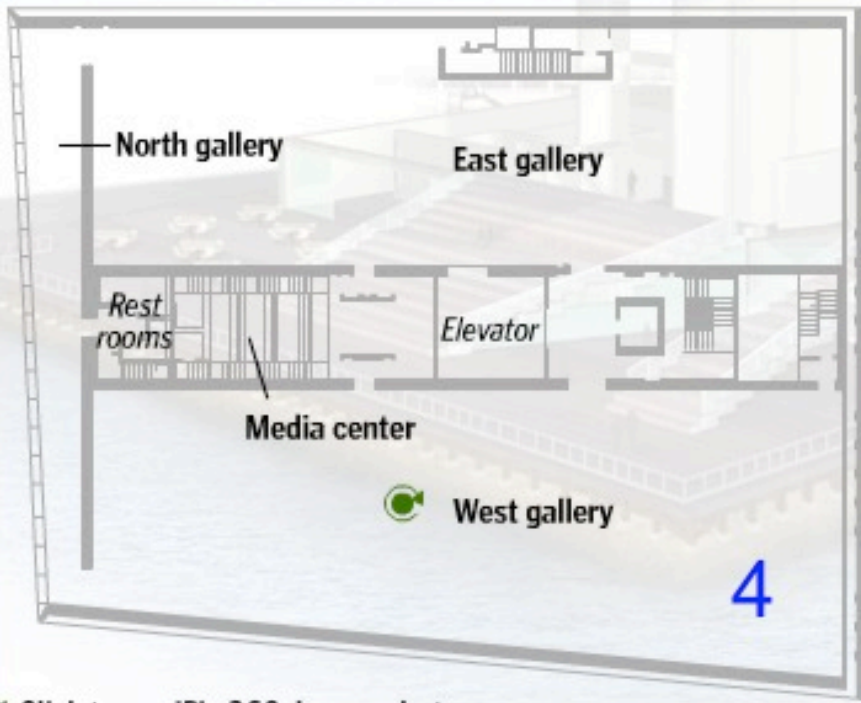
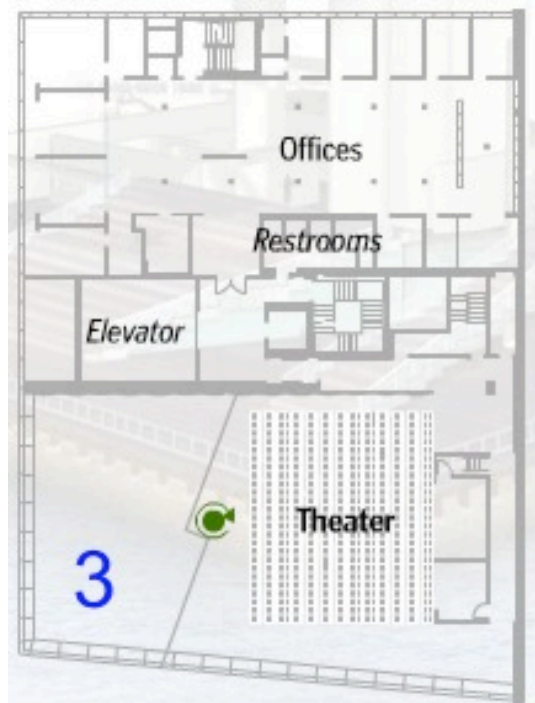
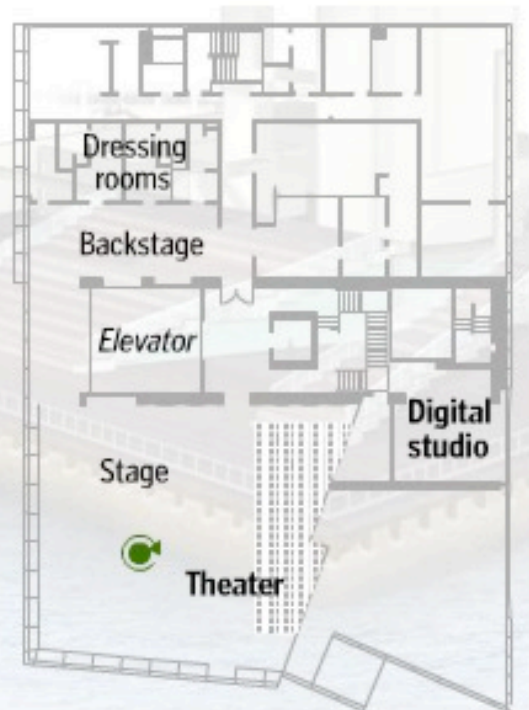
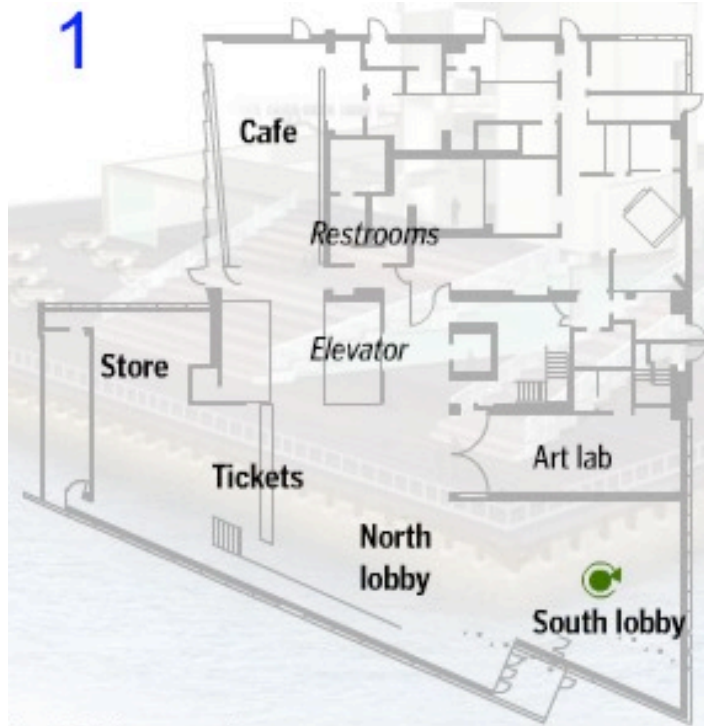

22 foot deep "megatruss"

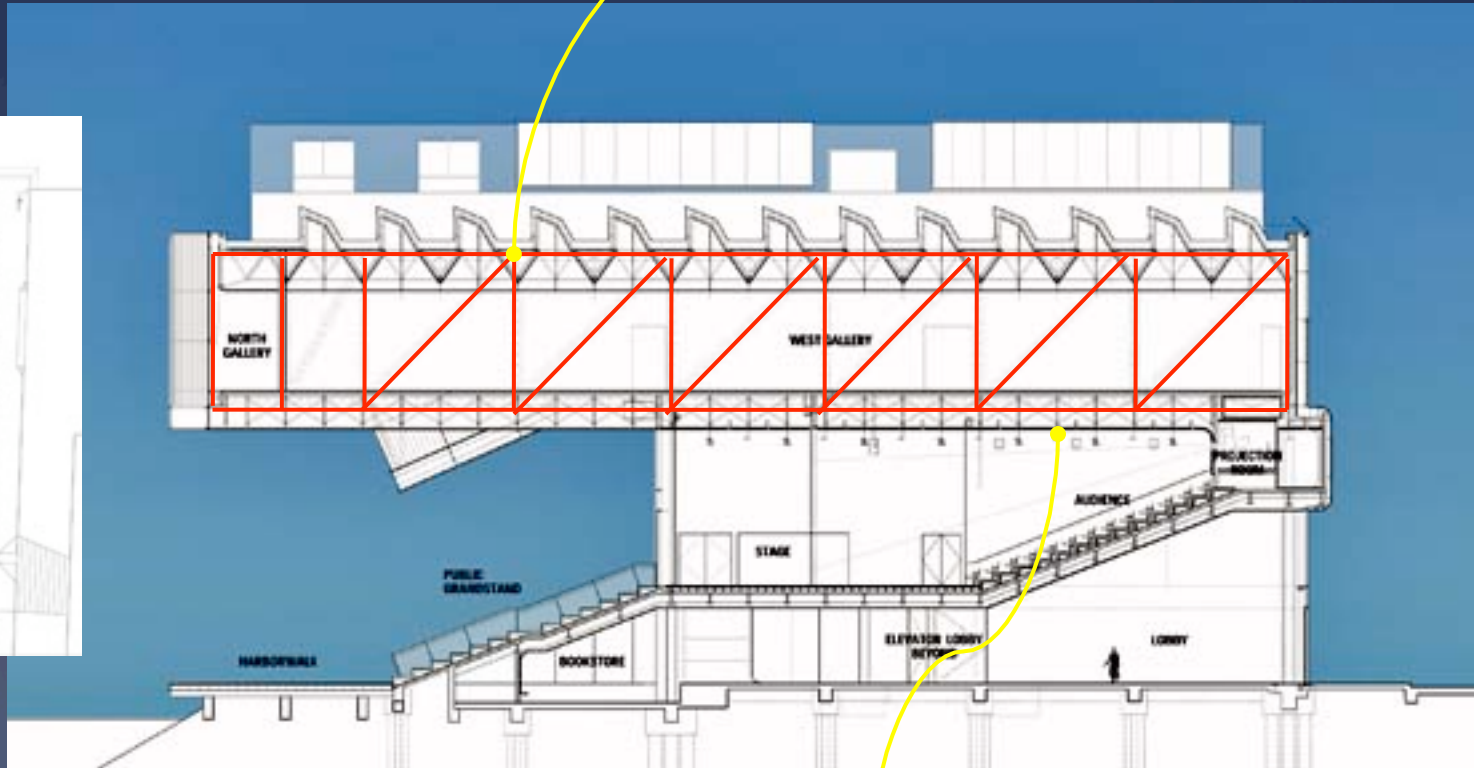

4 foot 4 inch deep spanning trusses

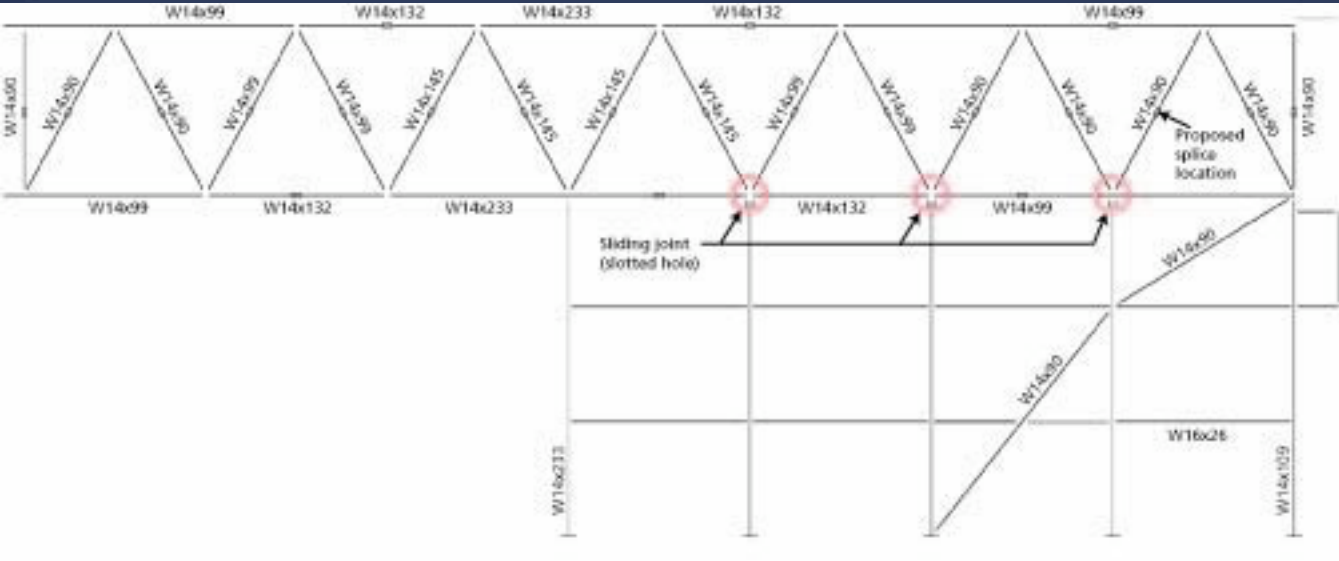

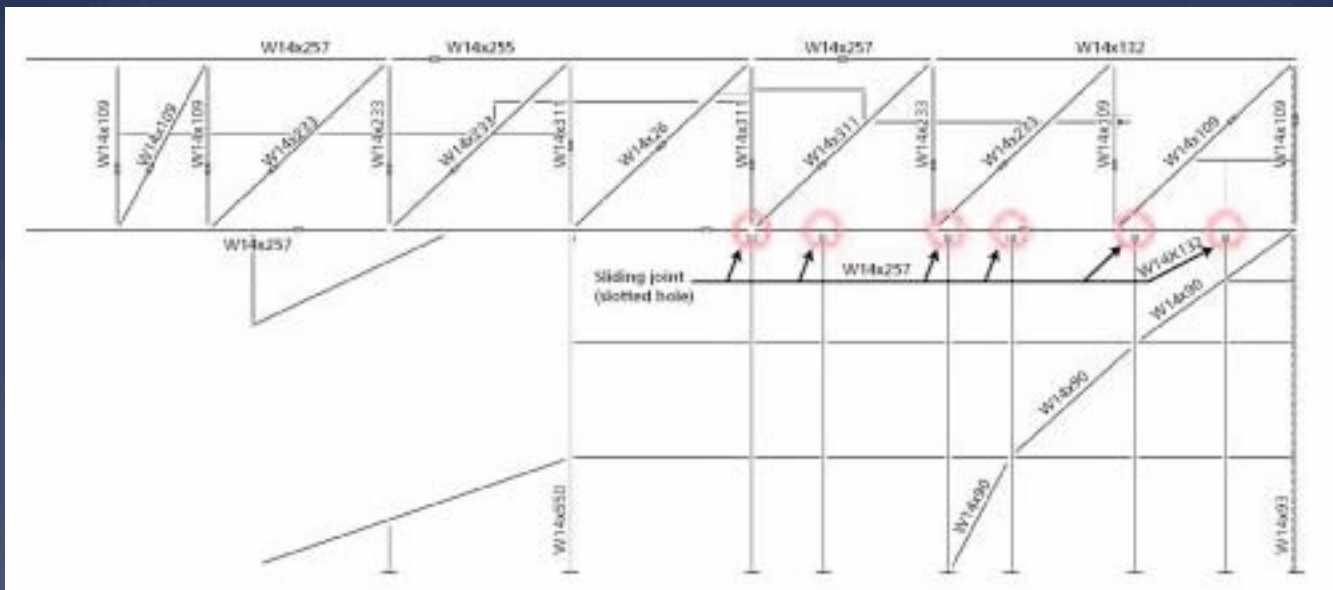











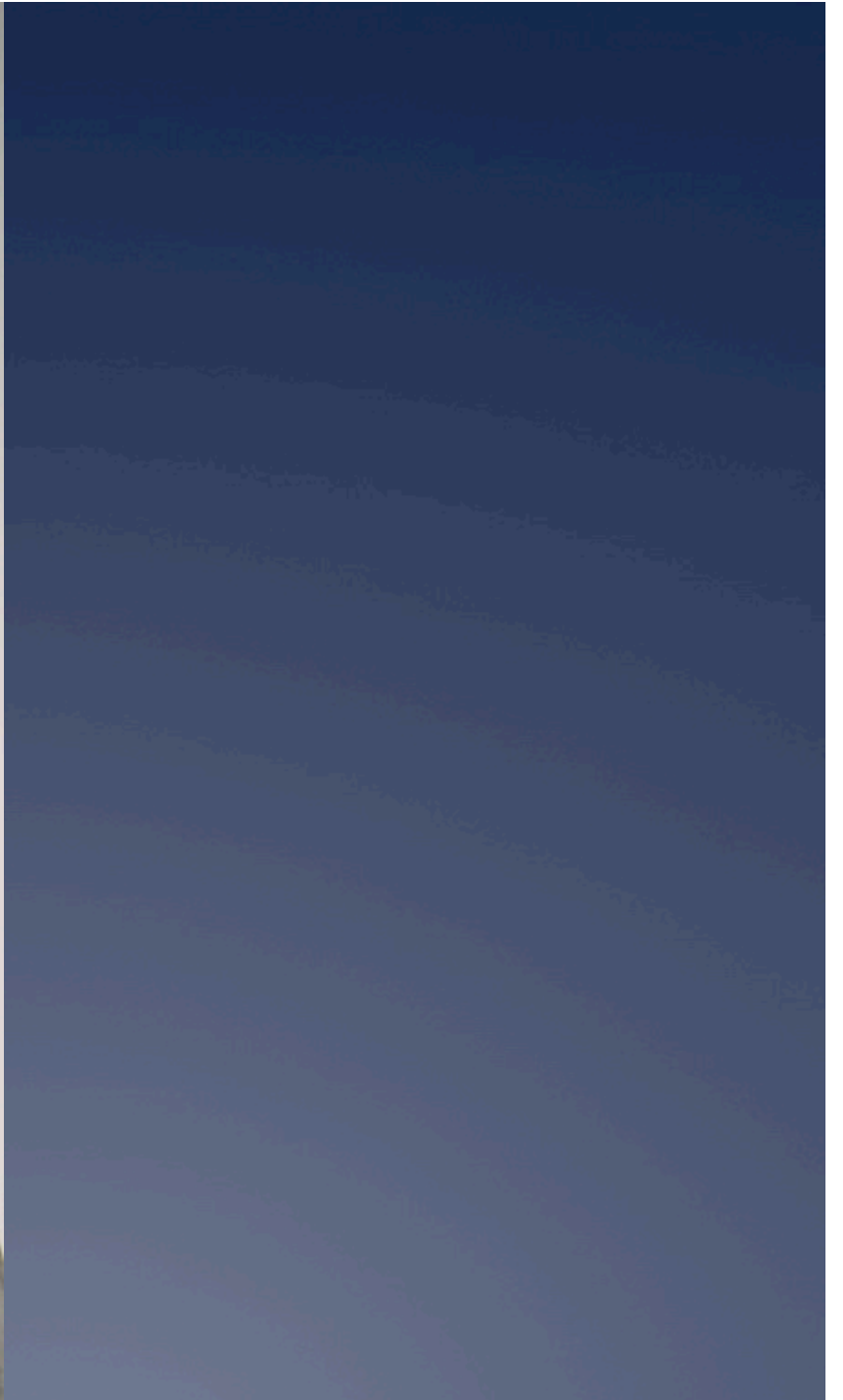

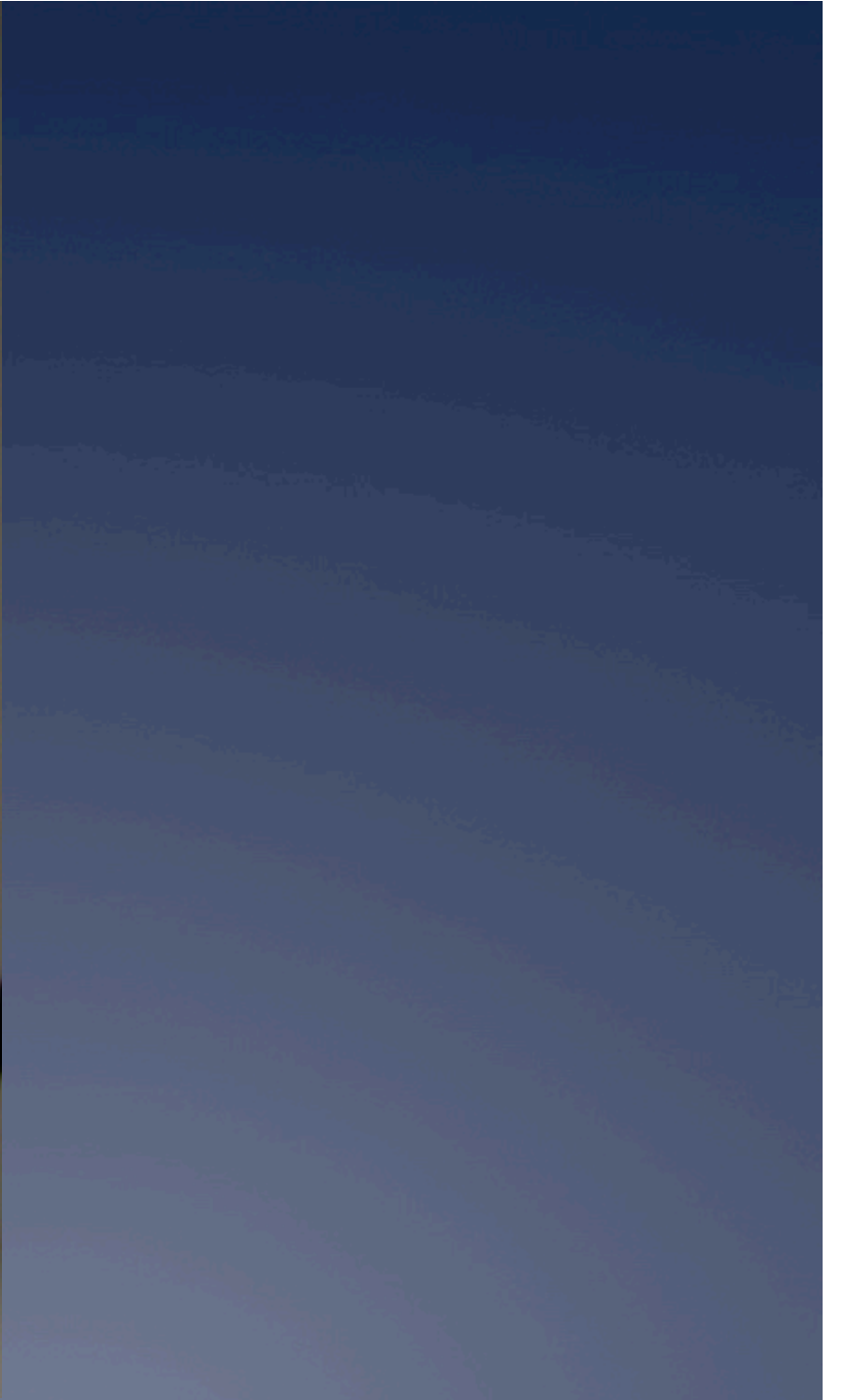







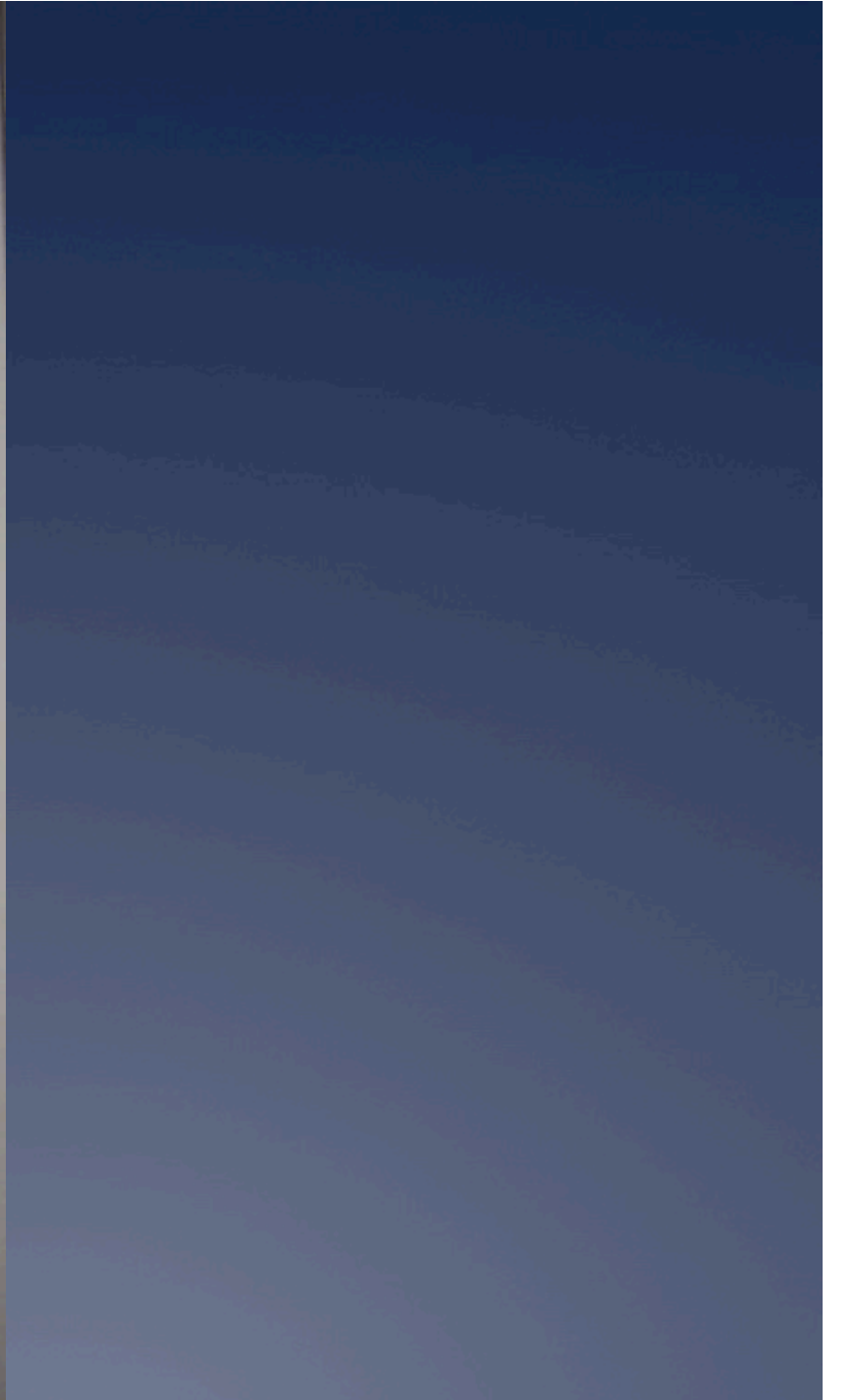

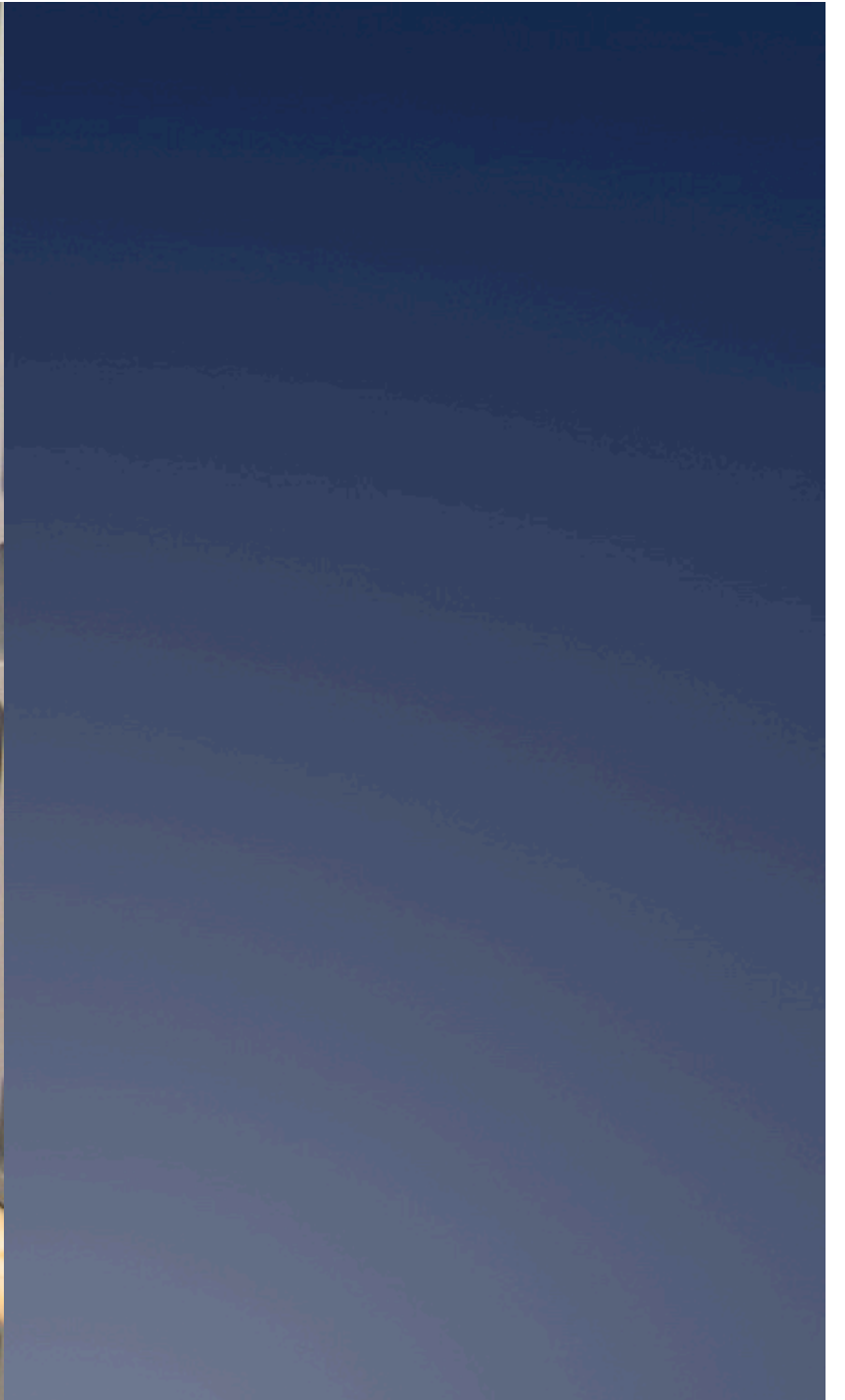
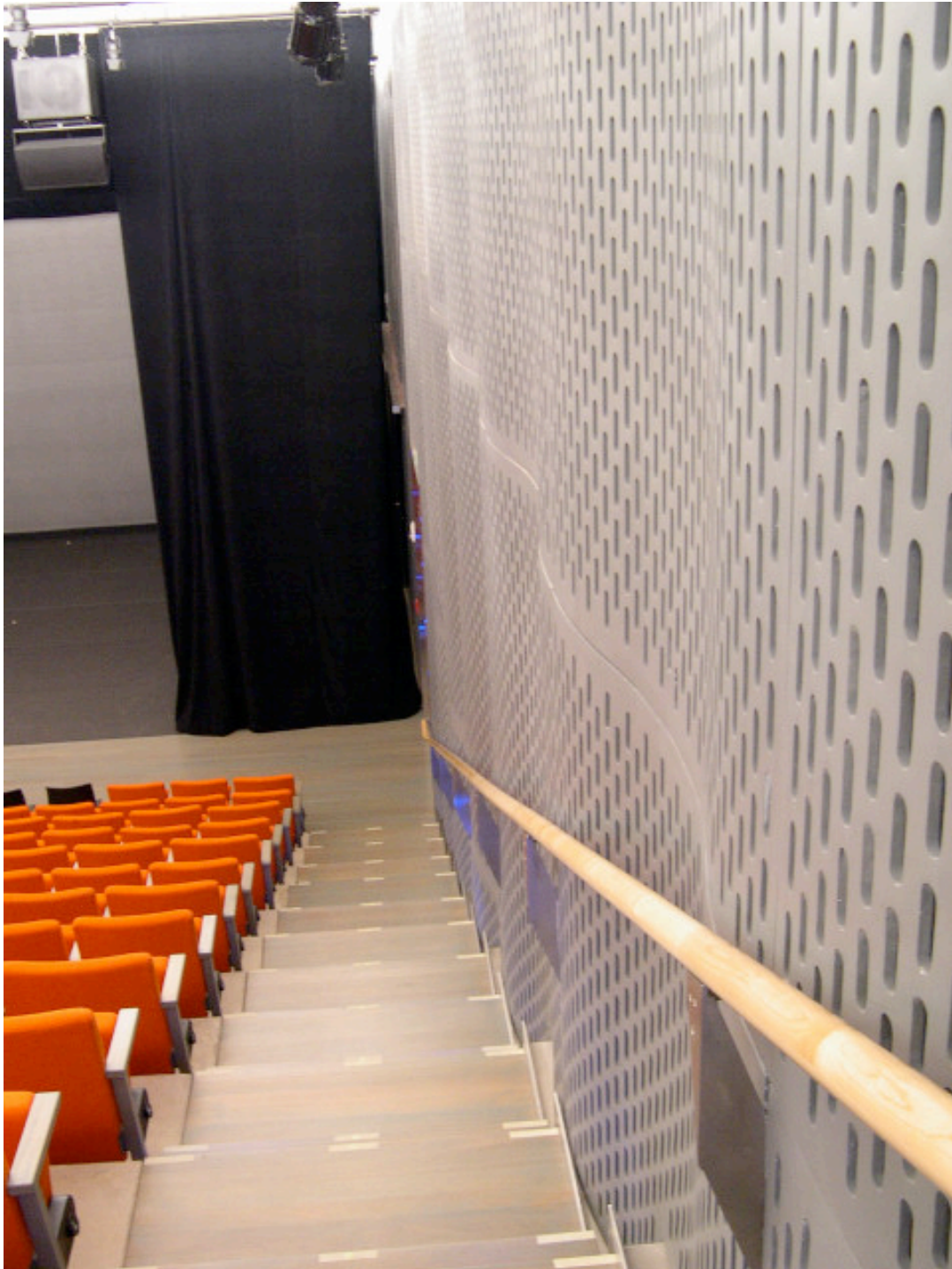





lobby







Water window day



Water window int





