

Winery as Hillside

Antinori Winery
Bargio, Italy
Archea Associati

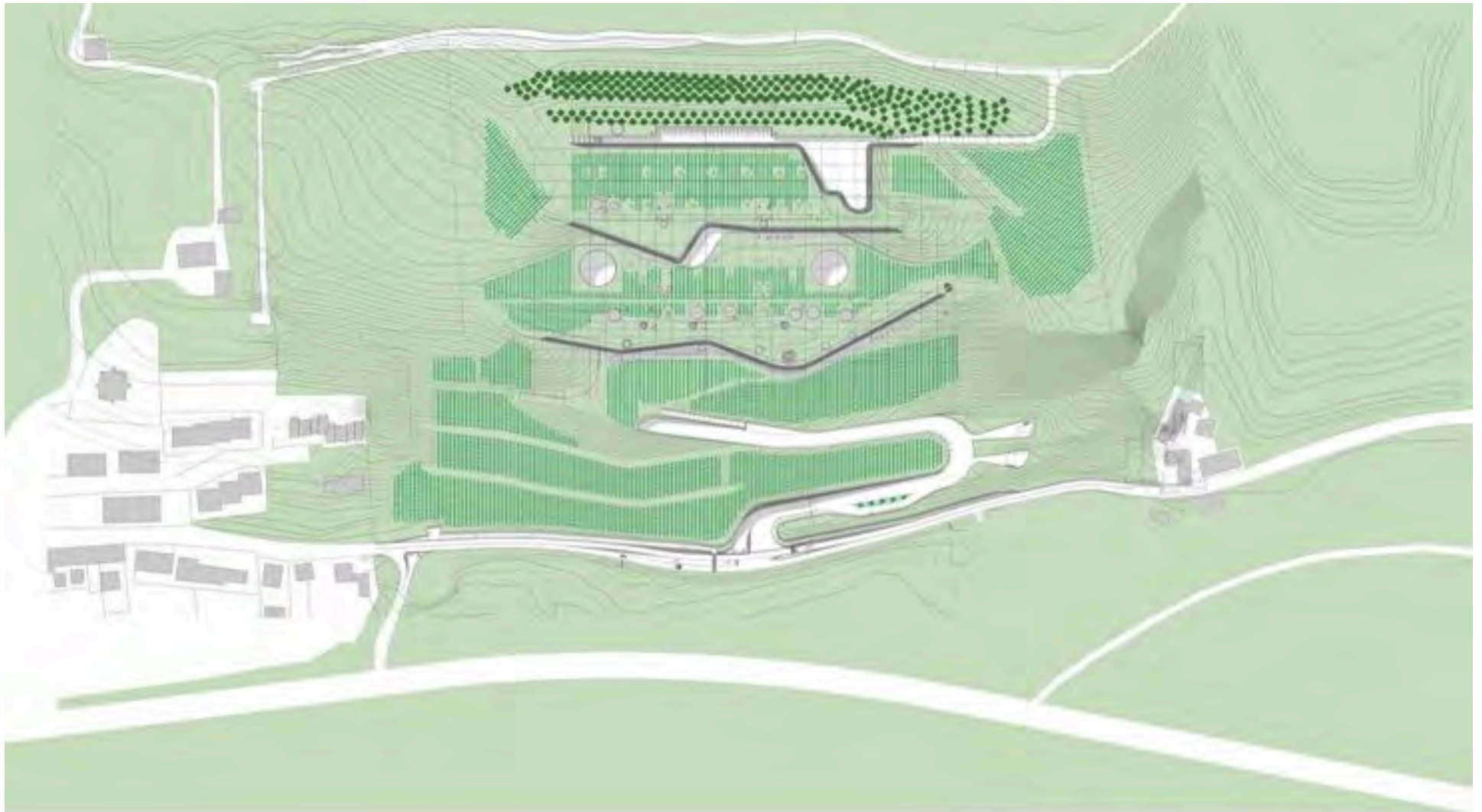



ARCHEA ASSOCIATI
CANTINANTHOSI
POTRIBO S.p.A.
progetto generale e piante site



Find a perfect hillside for grapes, dig it out, build a two floor building, put the soil back and start growing again



ARCHEA ASSOCIATI
CANTINA ANTINORI
ANTINORI WINERY

sezione GG / section GG

0 10 20 m

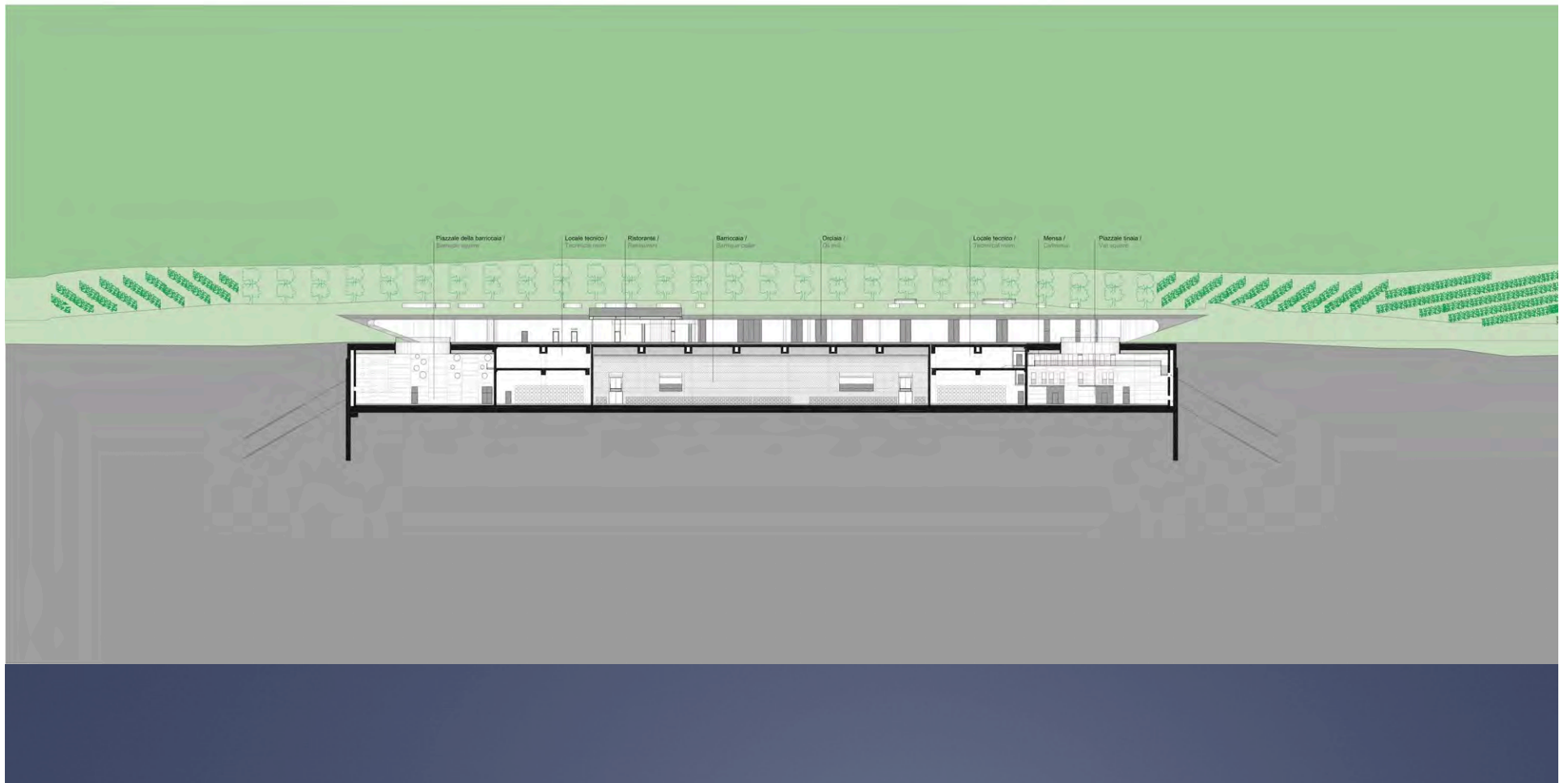
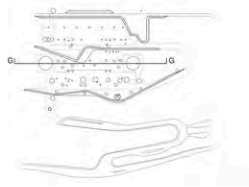

ARCHEA ASSOCIATI
CANTINA ANTINORI
ANTINORI WINERY

sezione BB / section BB

0 10 20 m

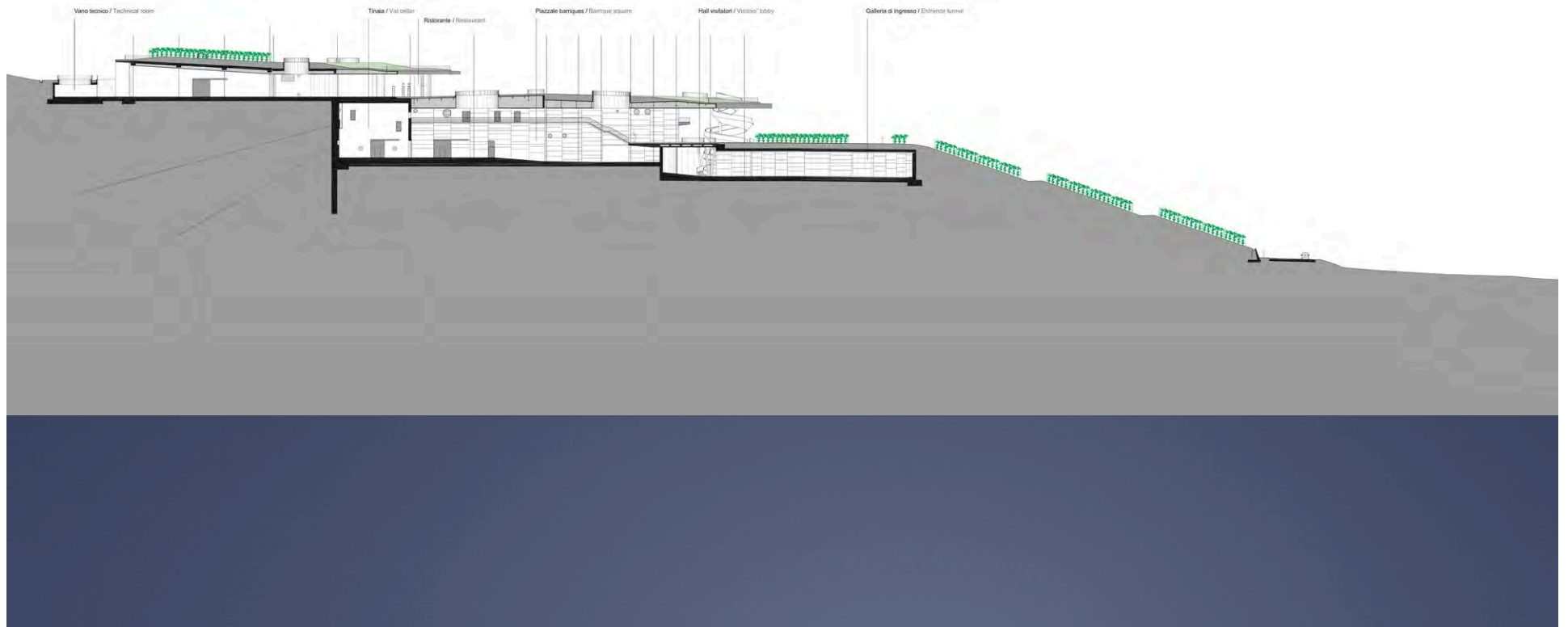
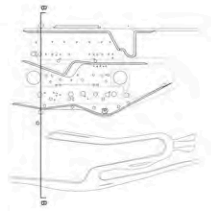

Vano tecnico / Technical room

Tinaja / Vat cellar

Ristorante / Restaurant

Piazza barocca / Baroque square

Hall visitatori / Visitors lobby

Galleria di ingresso / Entrance tunnel

■ PIANTA PRIMO LIVELLO / 1ST LEVEL FLOOR PLAN
CANTINA ANTINORI

1. Parcheggio bottaia
2. Bottaia
3. Riserva della casa
4. Piazzale barriques
5. Barricaia
6. Piazzale tini
7. Tinaia
8. Camera presse

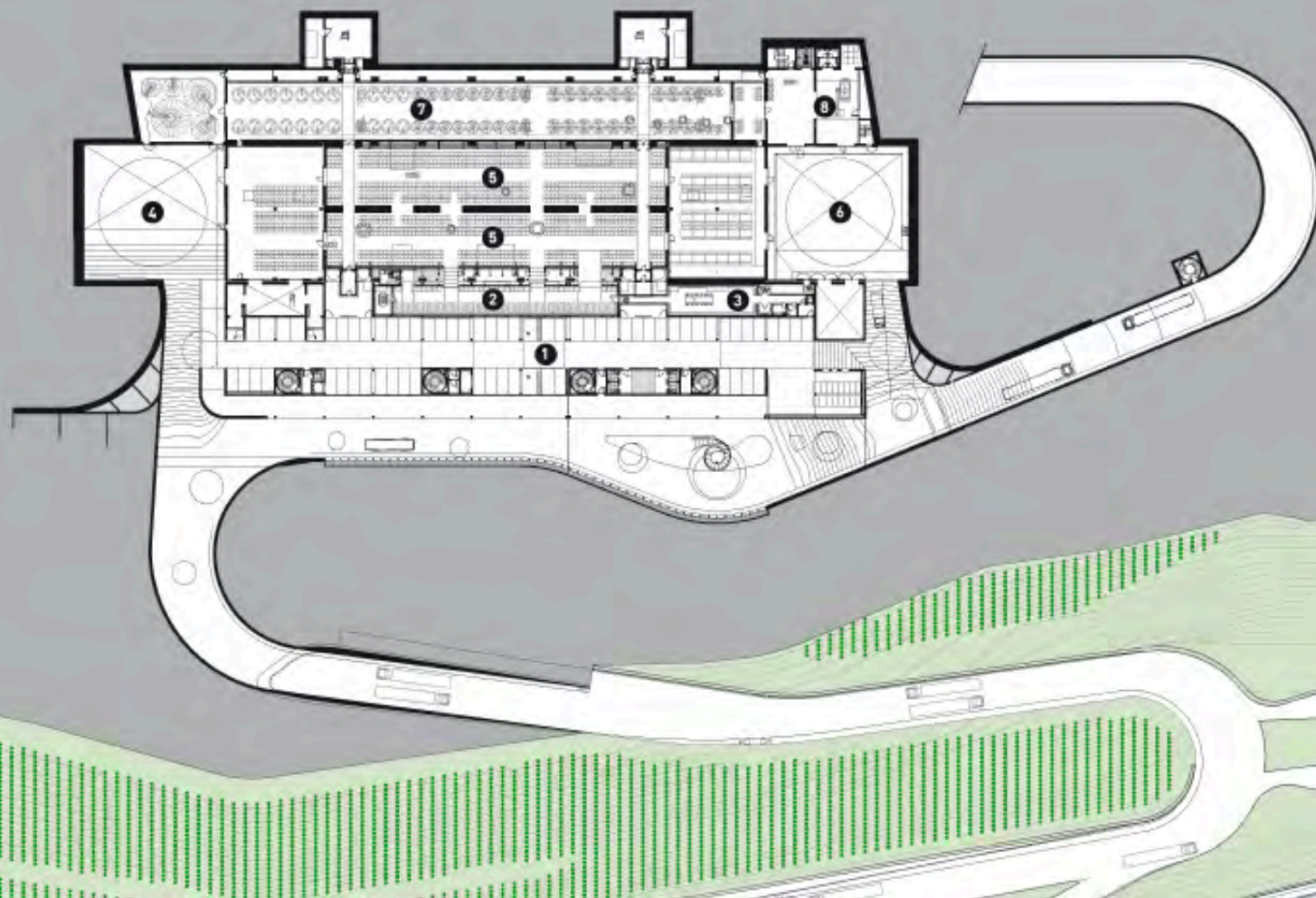

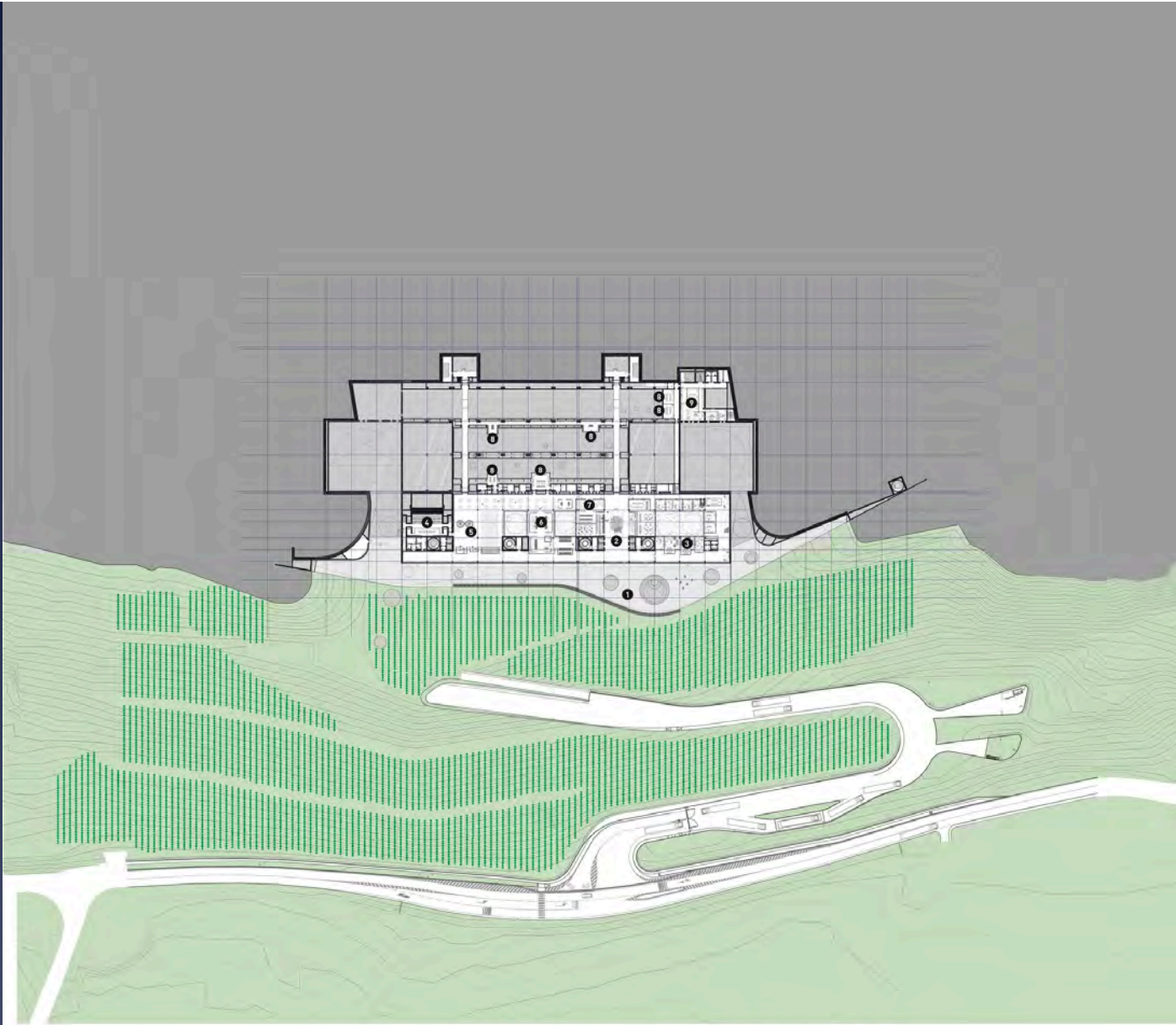

Pianta quota +174.00 / Plan level +174.00

1. Terrazza / Terrace
2. Reception
3. Uffici / Offices
4. Auditorium
5. Museo / Museum
6. Bottega / Shop
7. Sala d'attesa / Waiting room
8. Sala degustazione / tasting room
9. Laboratorio / Workshop

ARCHEA ASSOCIATI
CANTINA ANTINORI
ANTINORI WINERY

pianta quota +174.00 / plan level +174.00

0 10 30 60 m

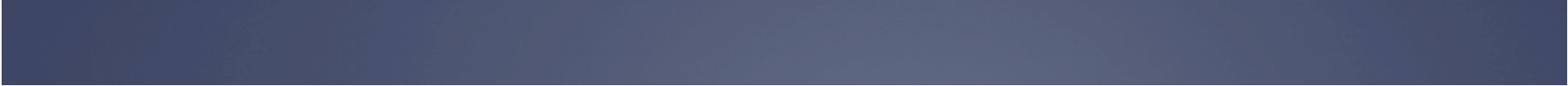
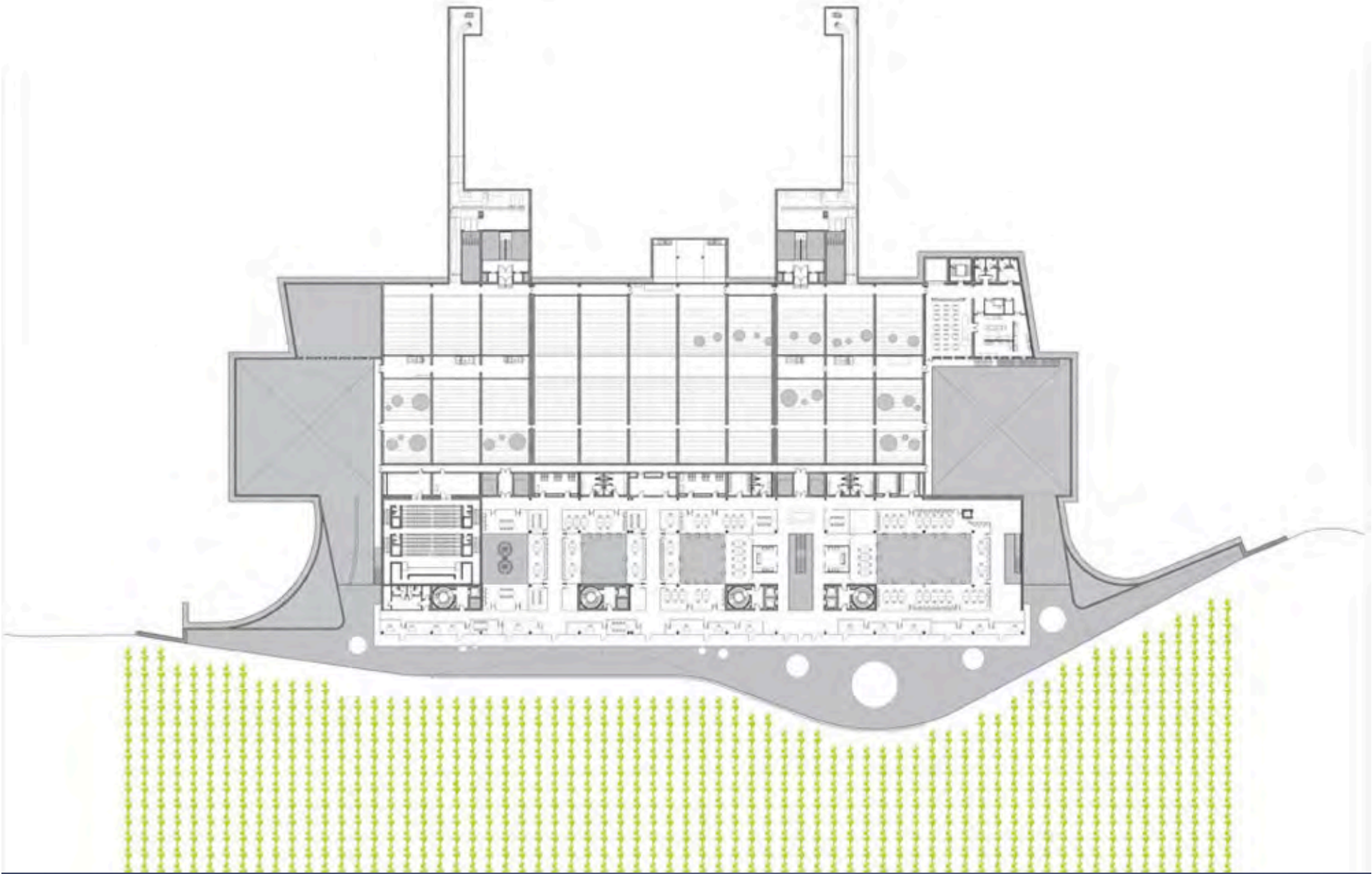





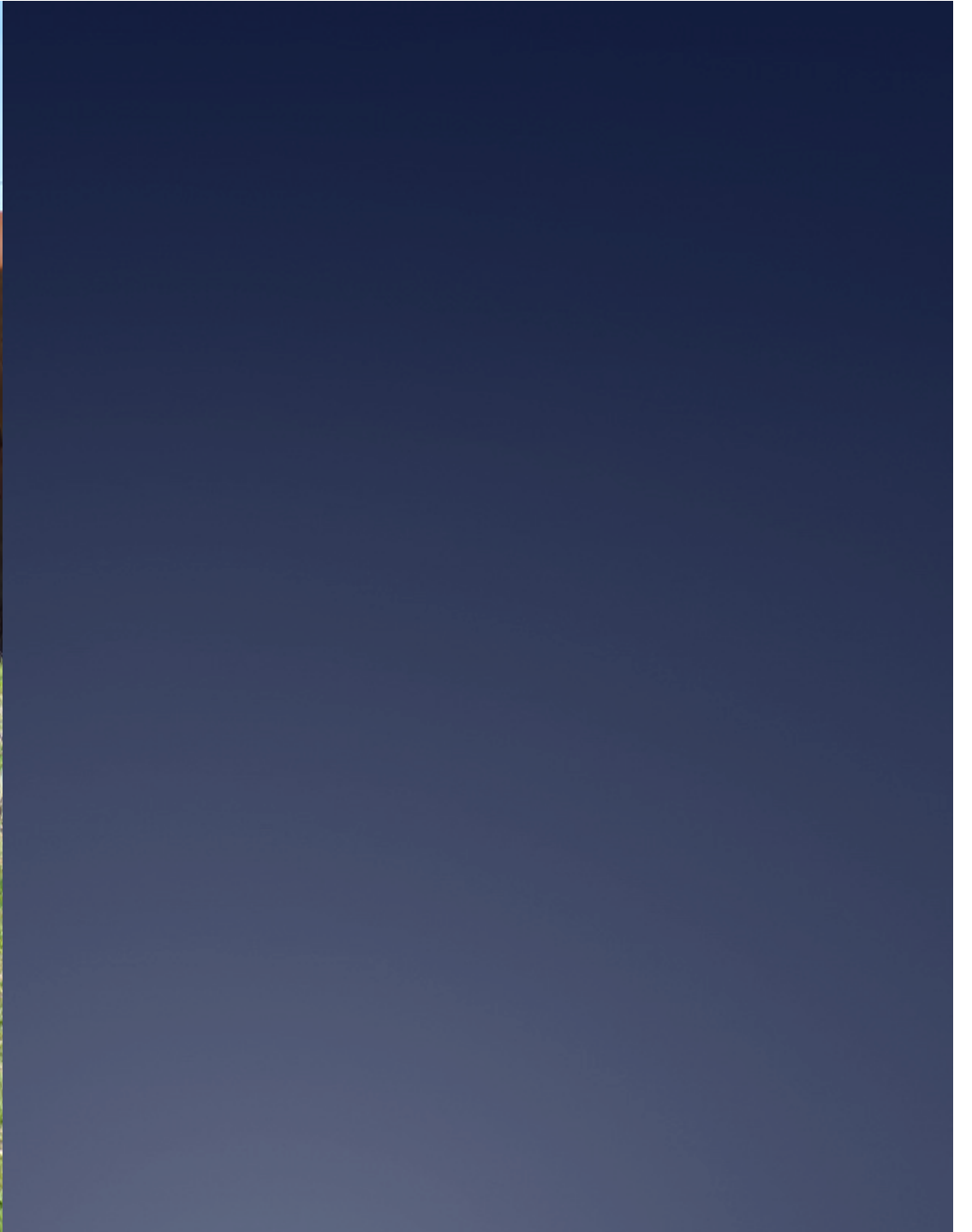



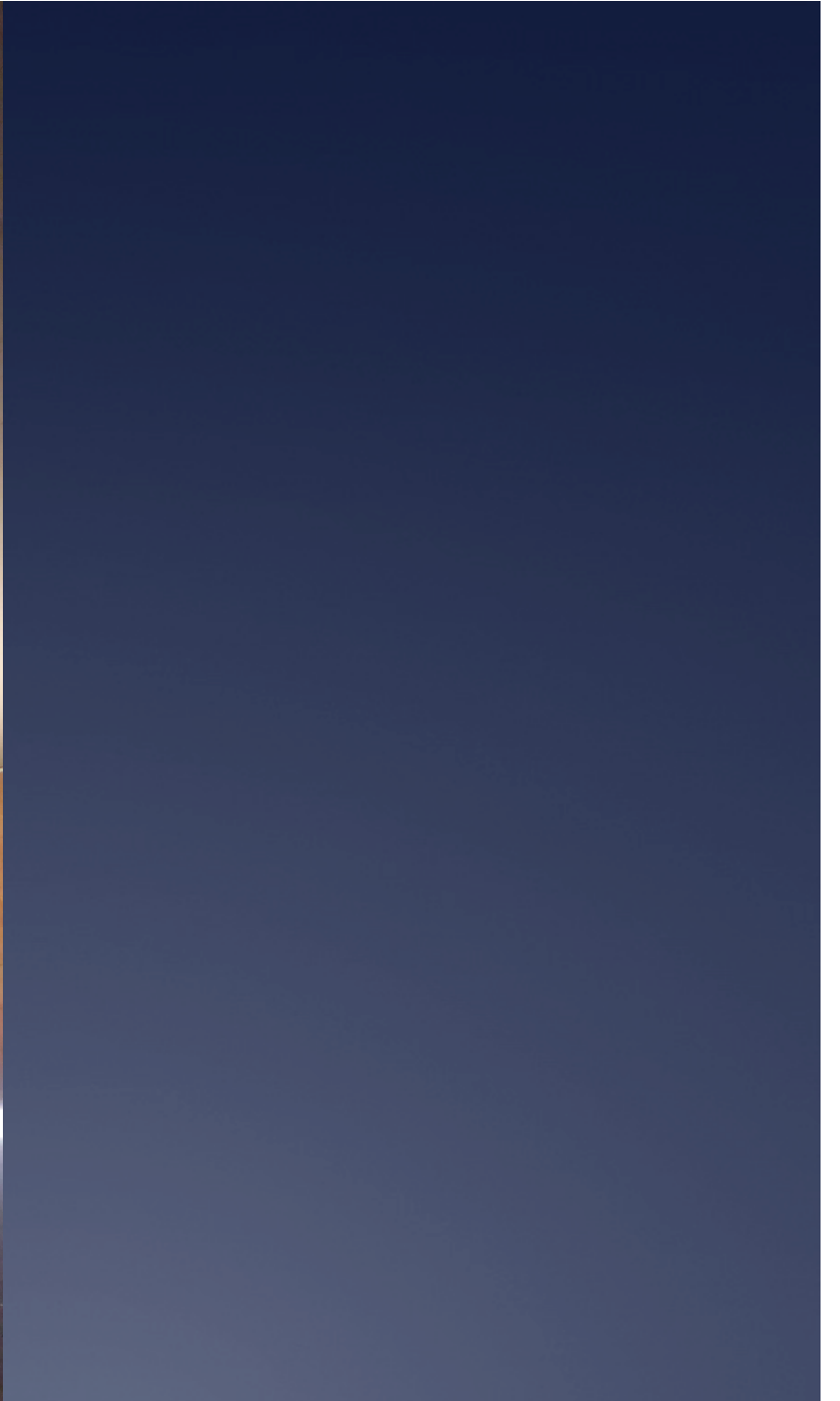

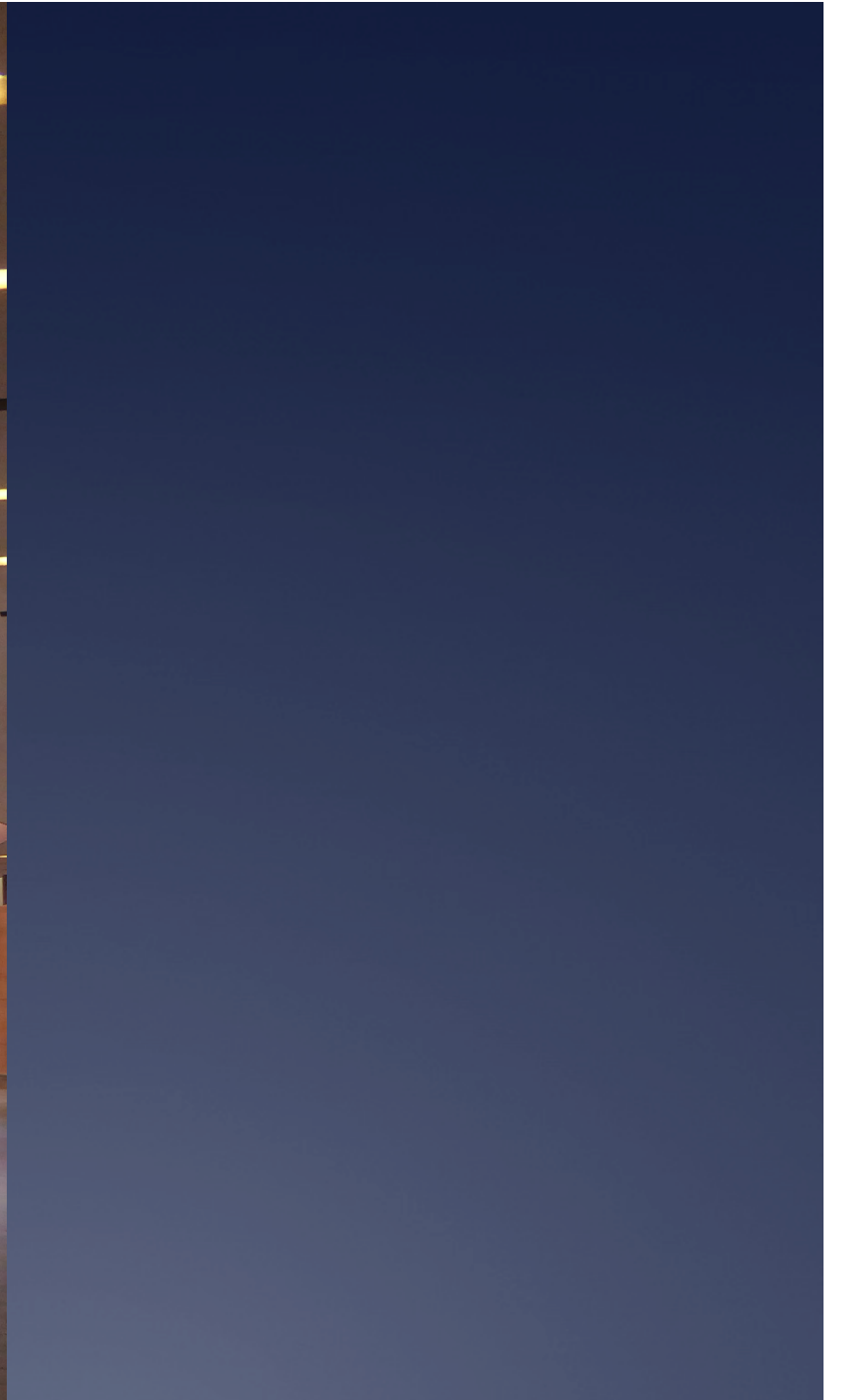

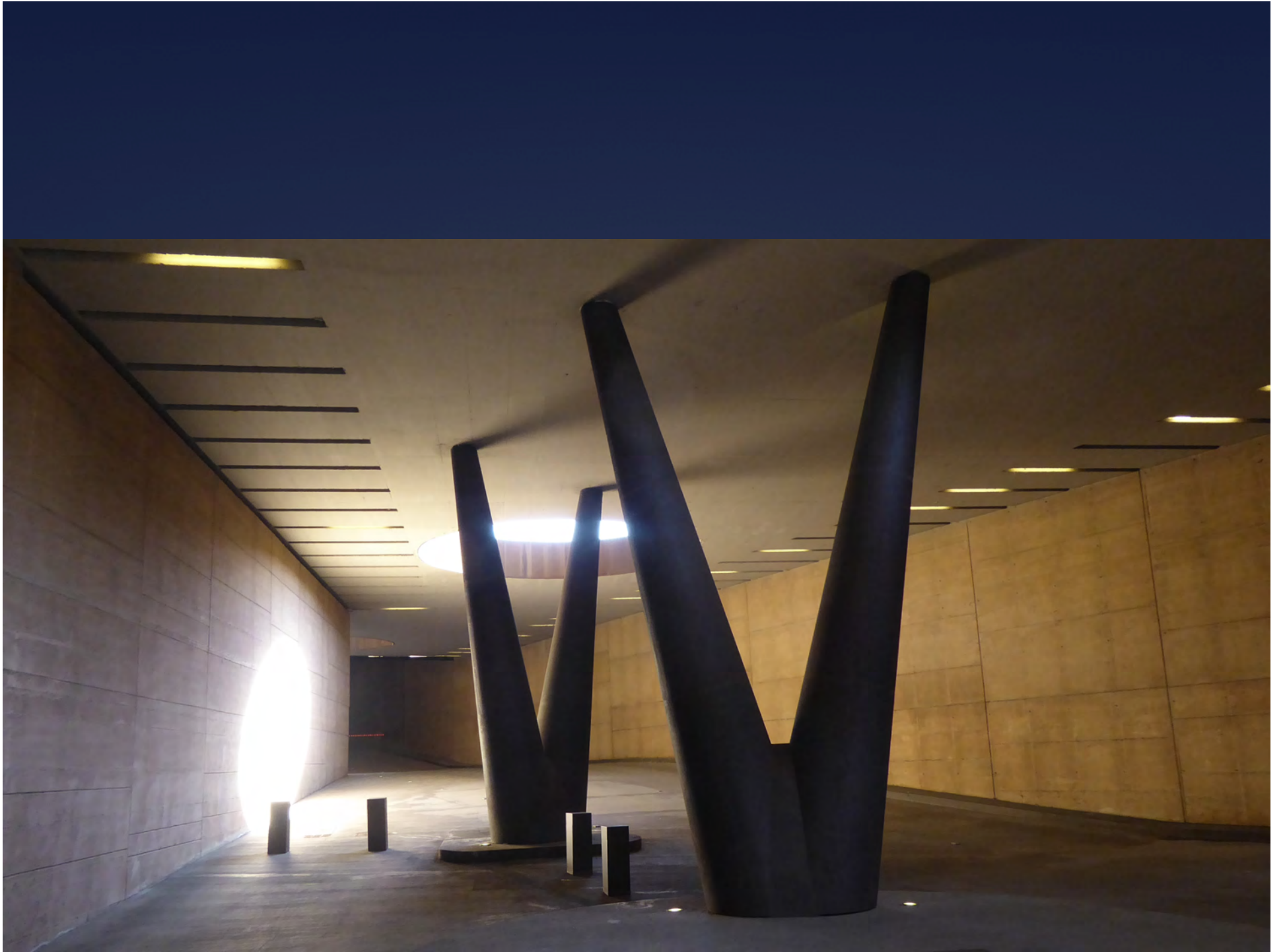

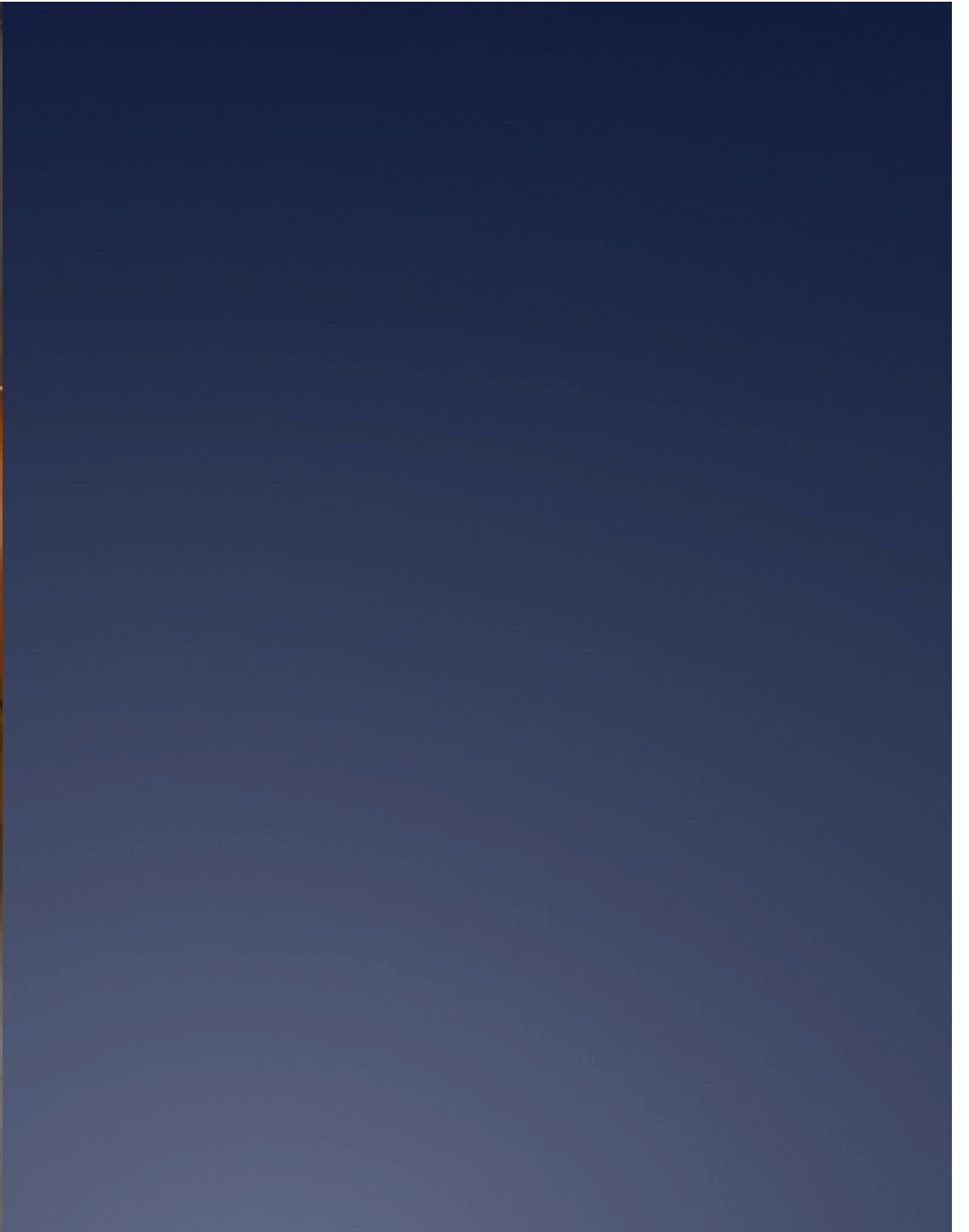

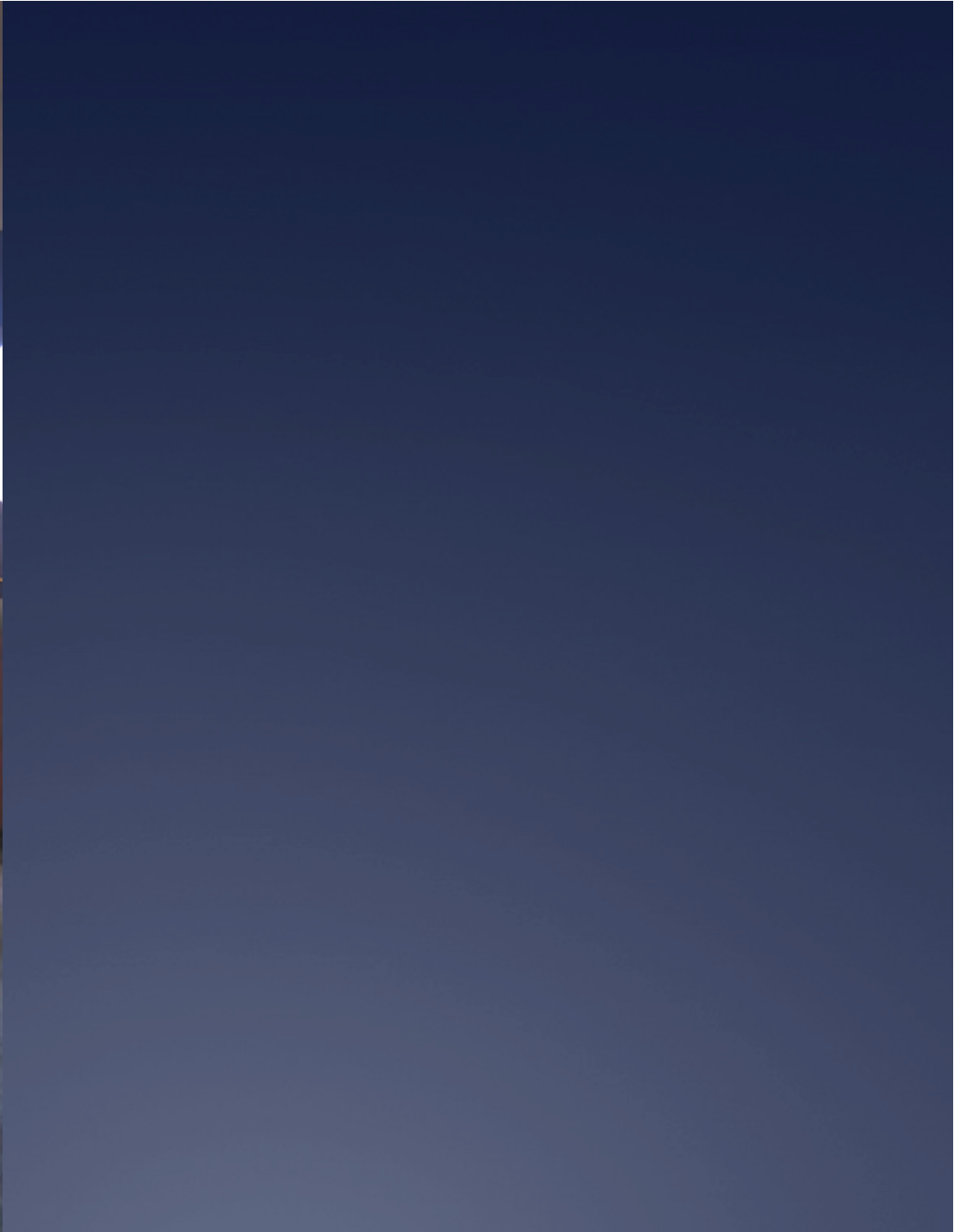



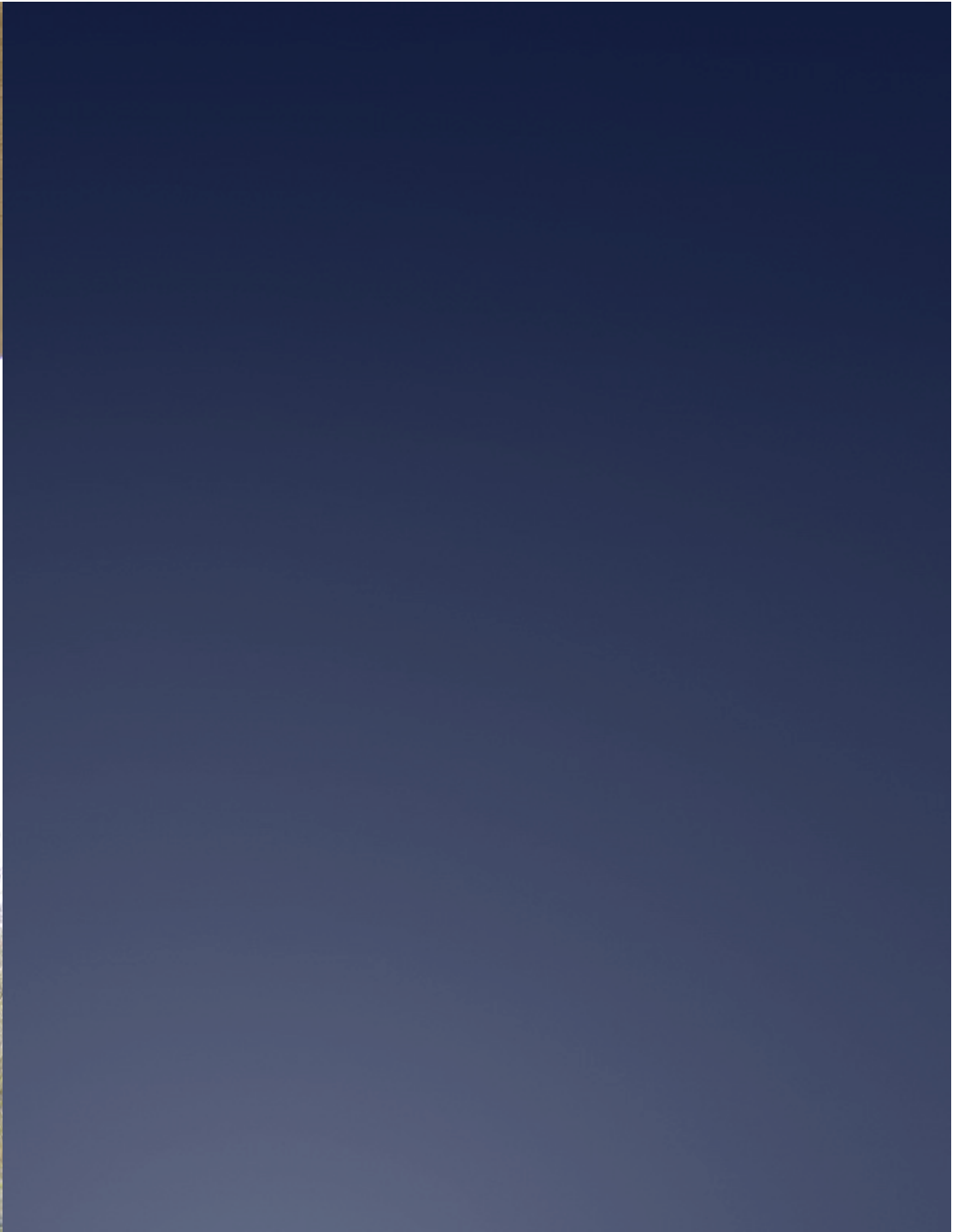

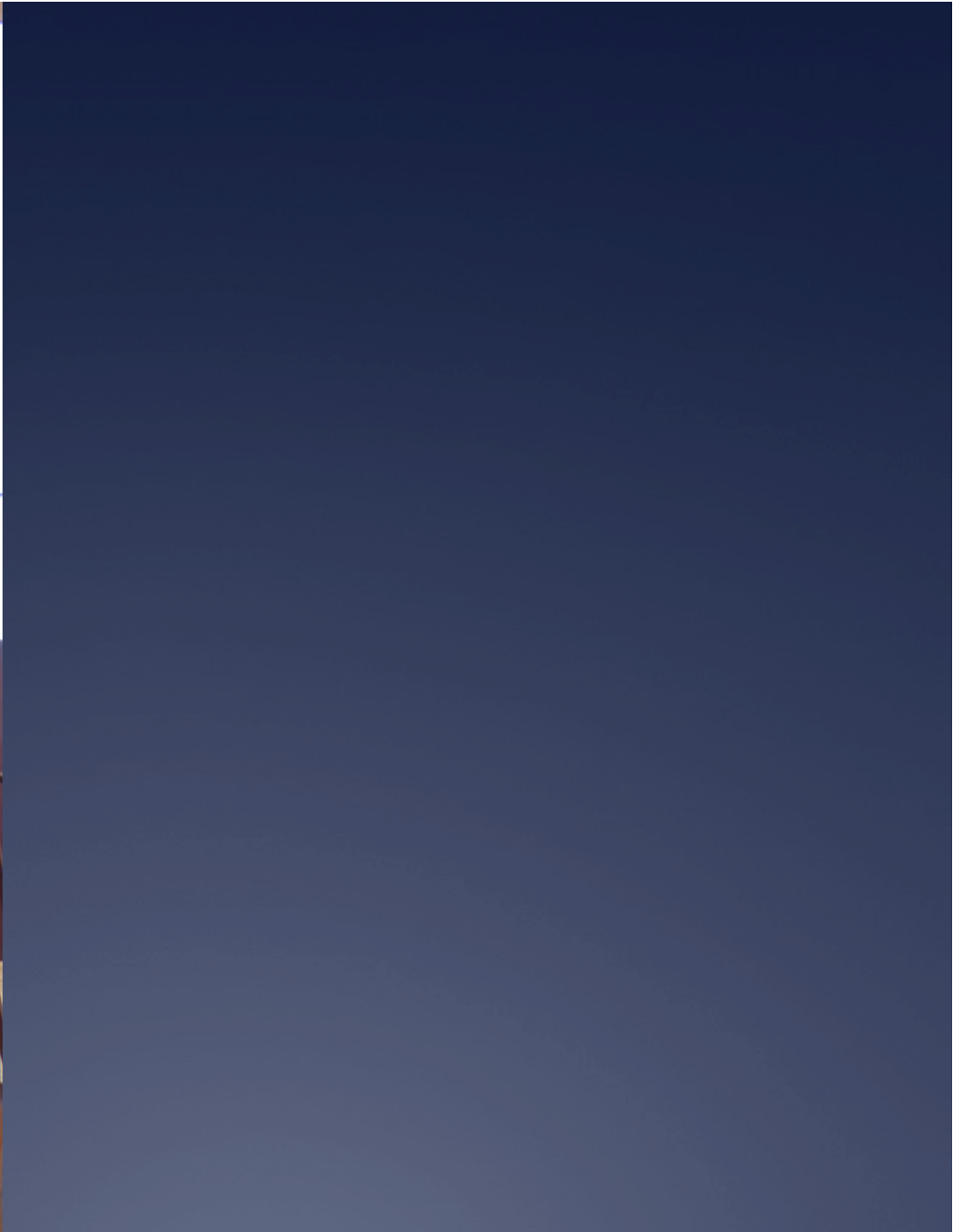

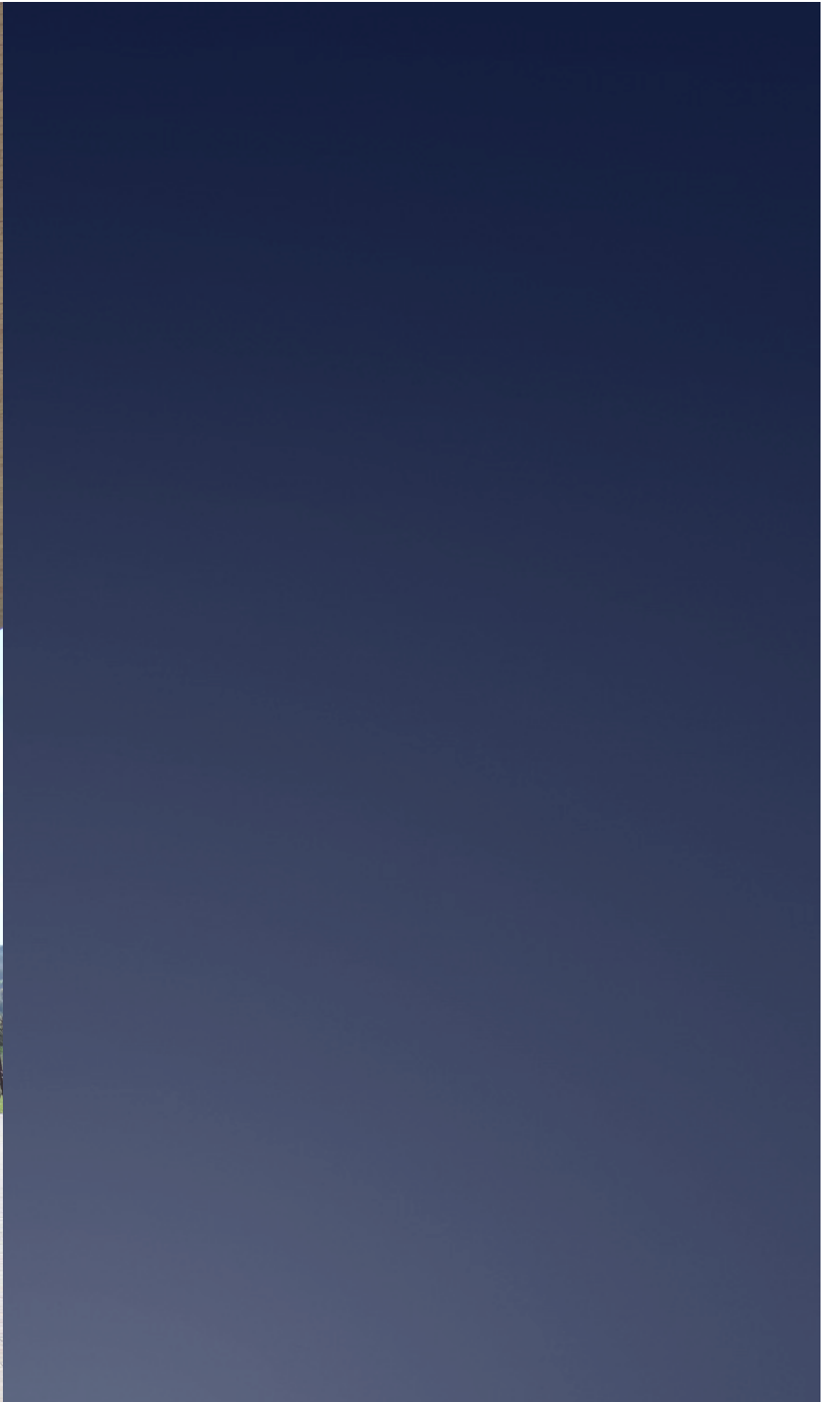

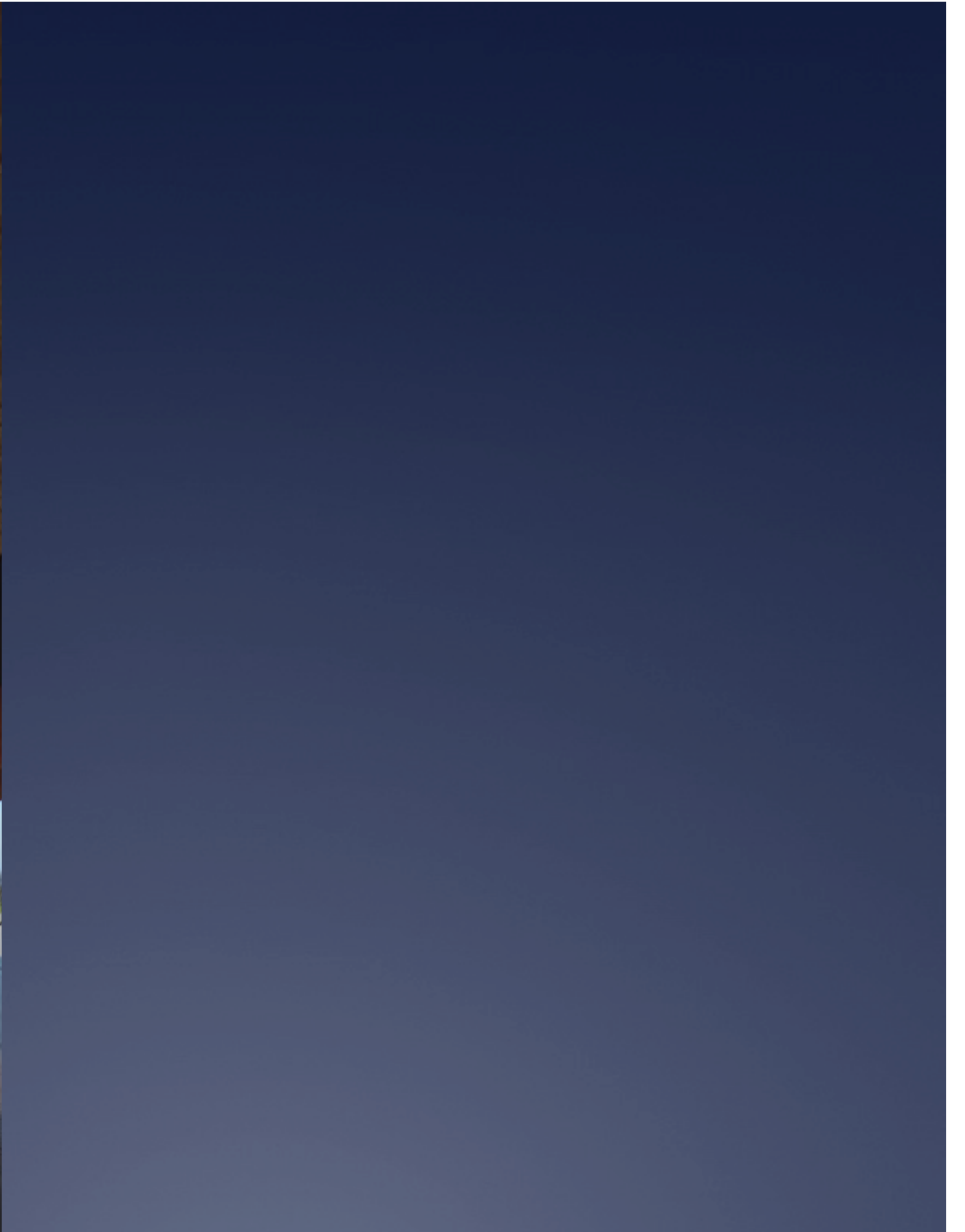

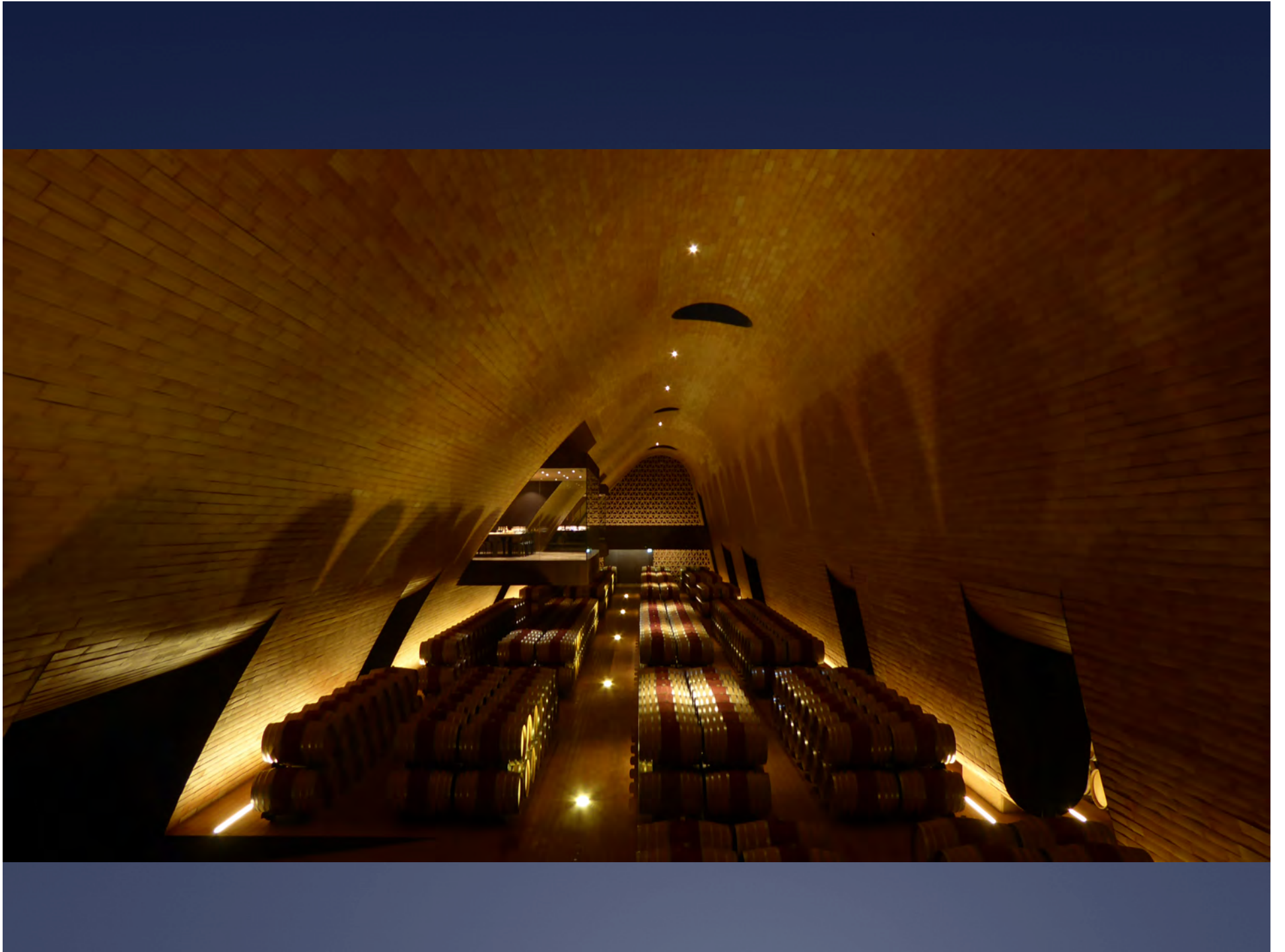

ARCHEA ASSOCIATI
CANTINA ANTINORI
ANTINORI WINERY

Dettaglio delle sezioni
della bottaia
Details of the sections
of the cellar

0 1 2m

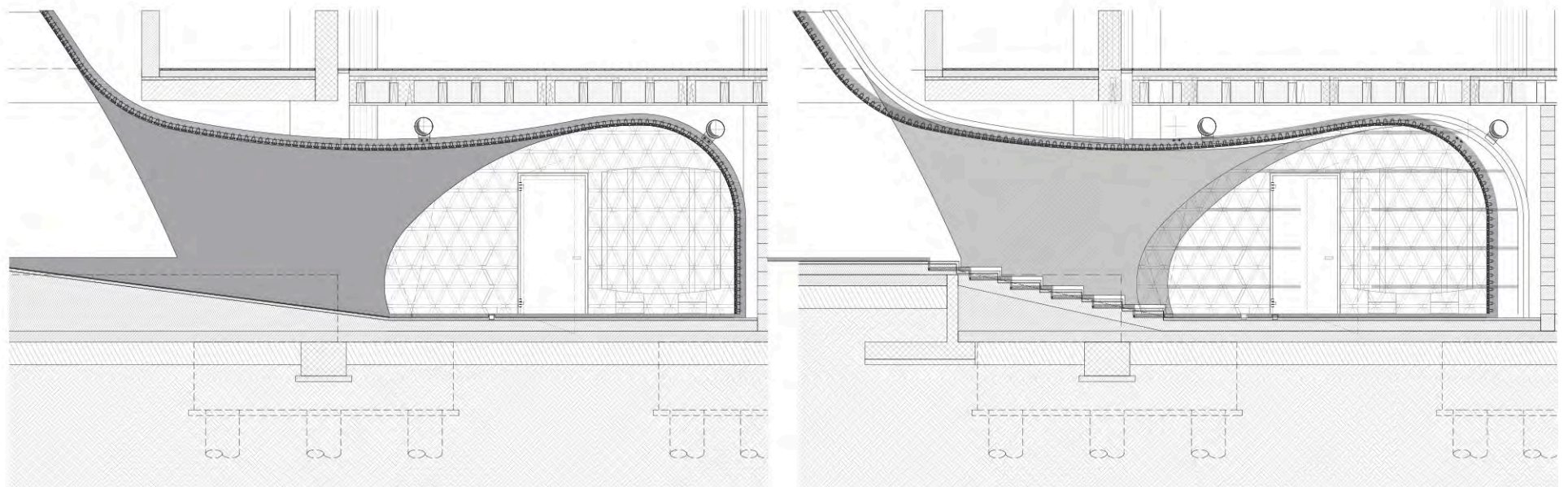

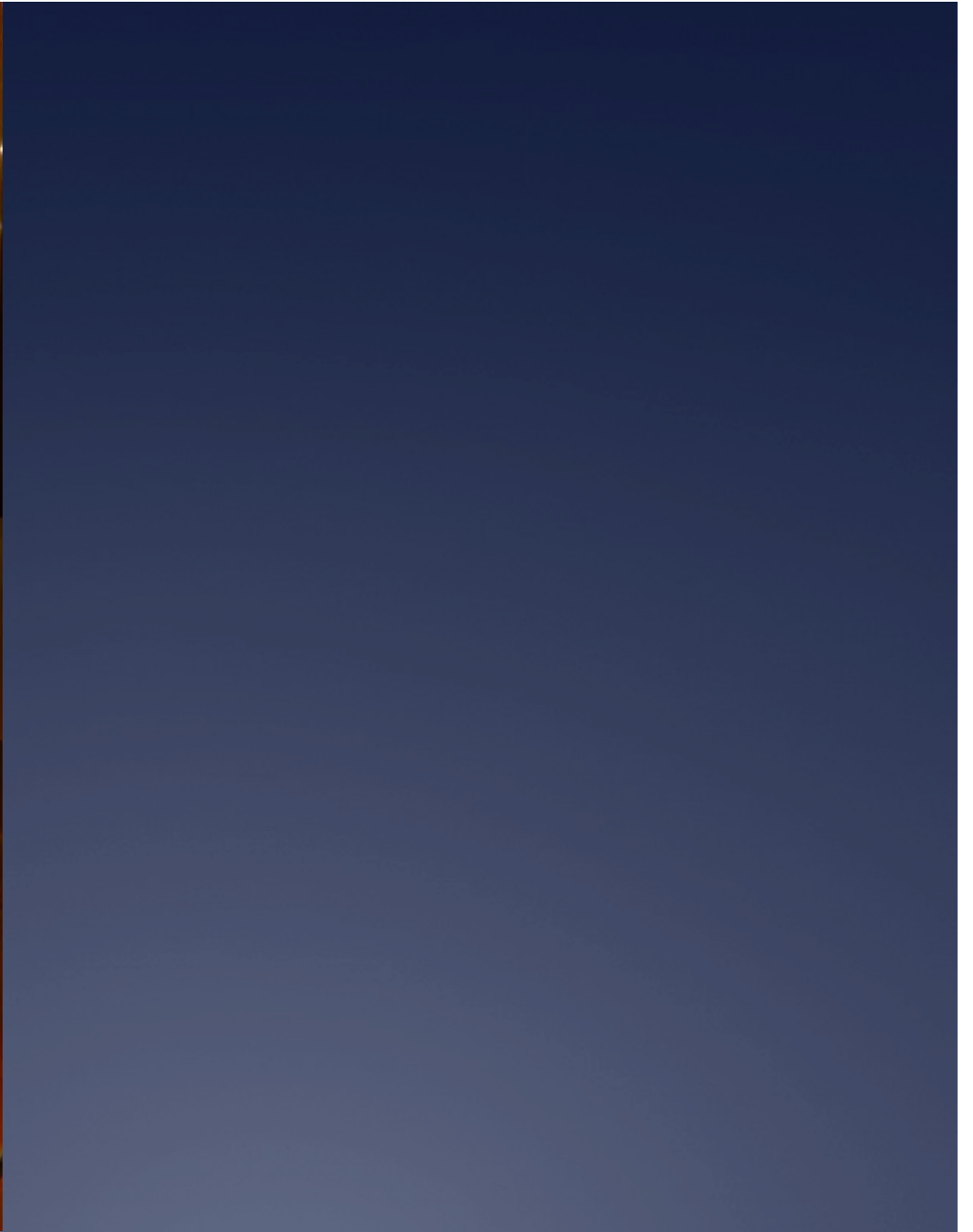

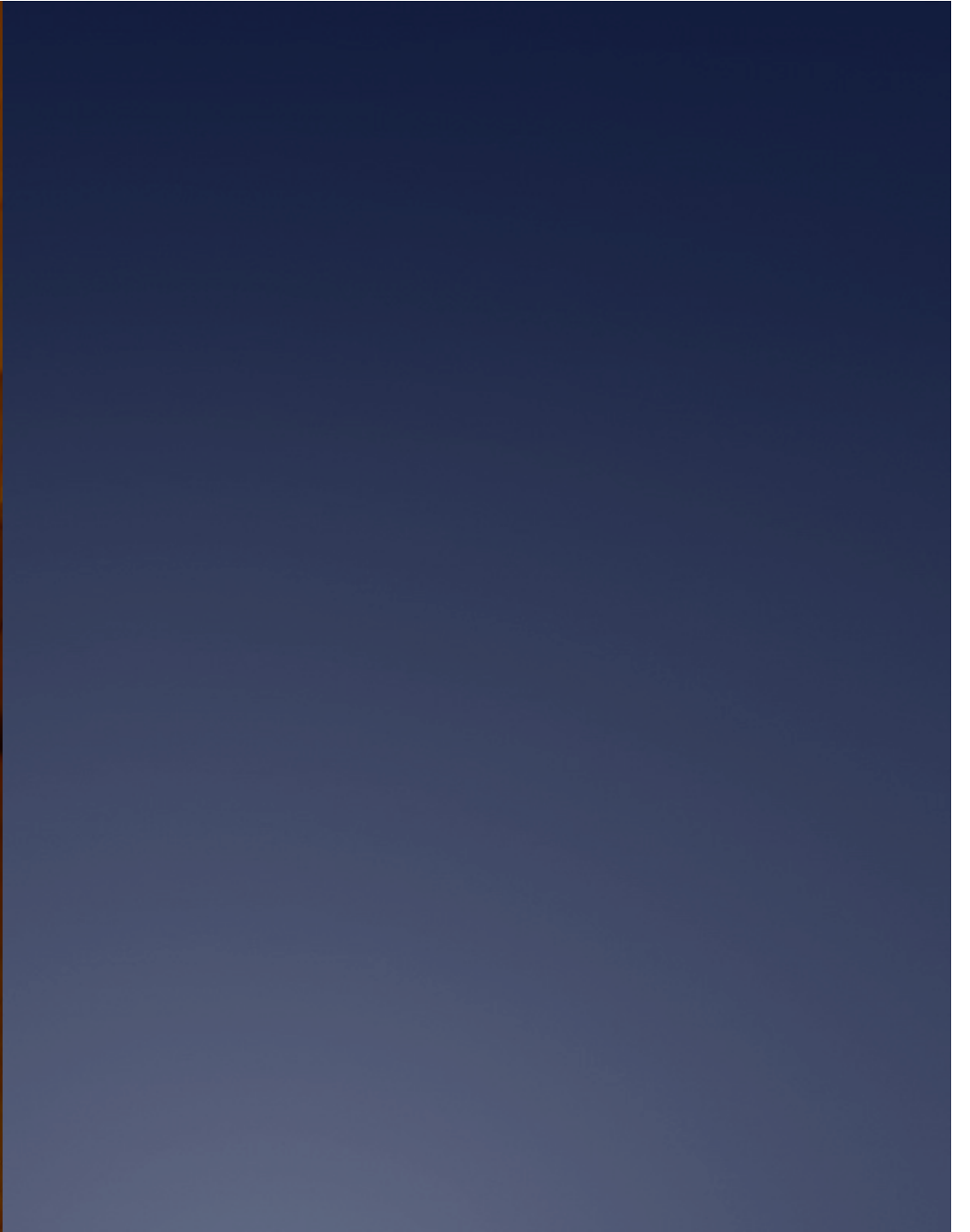

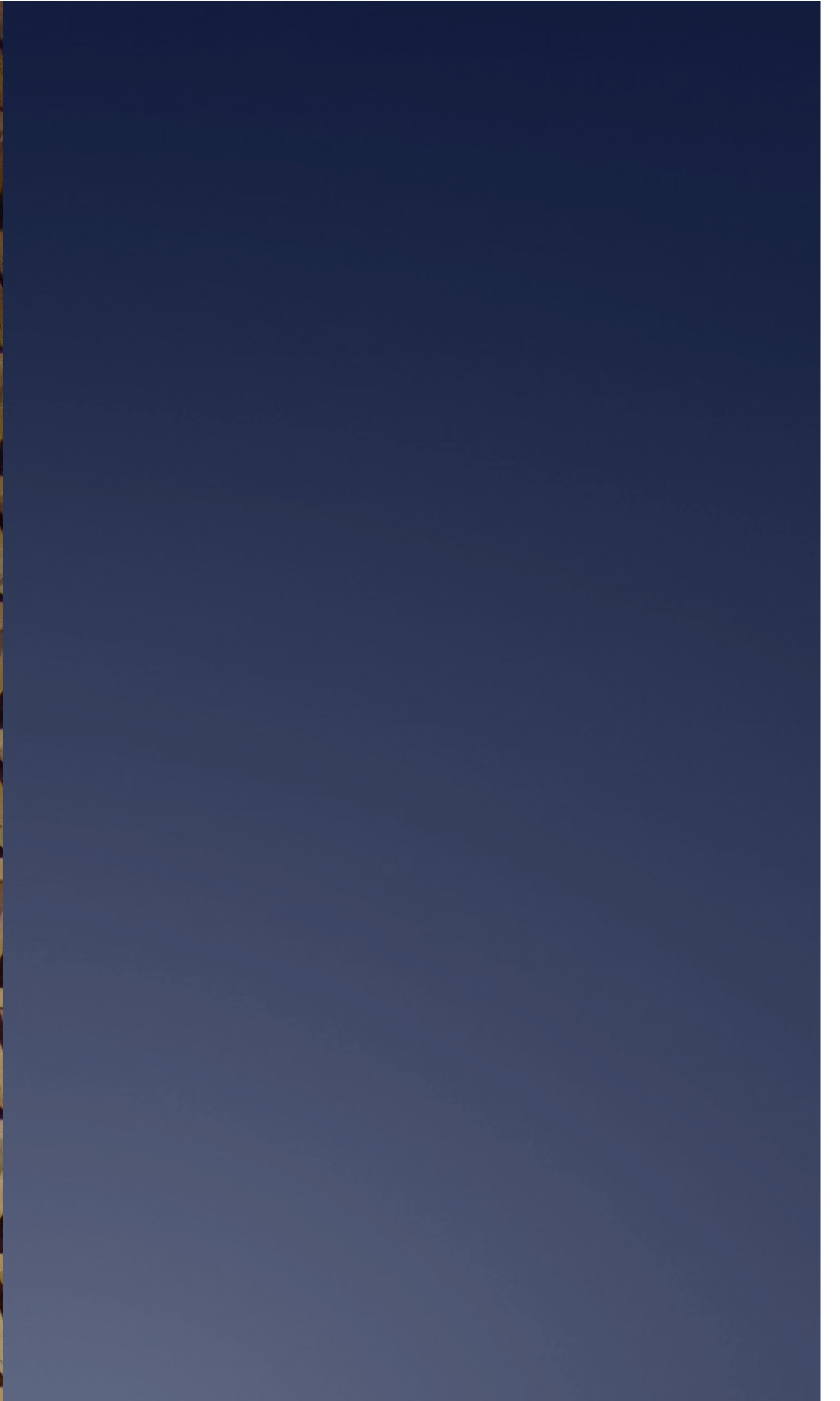
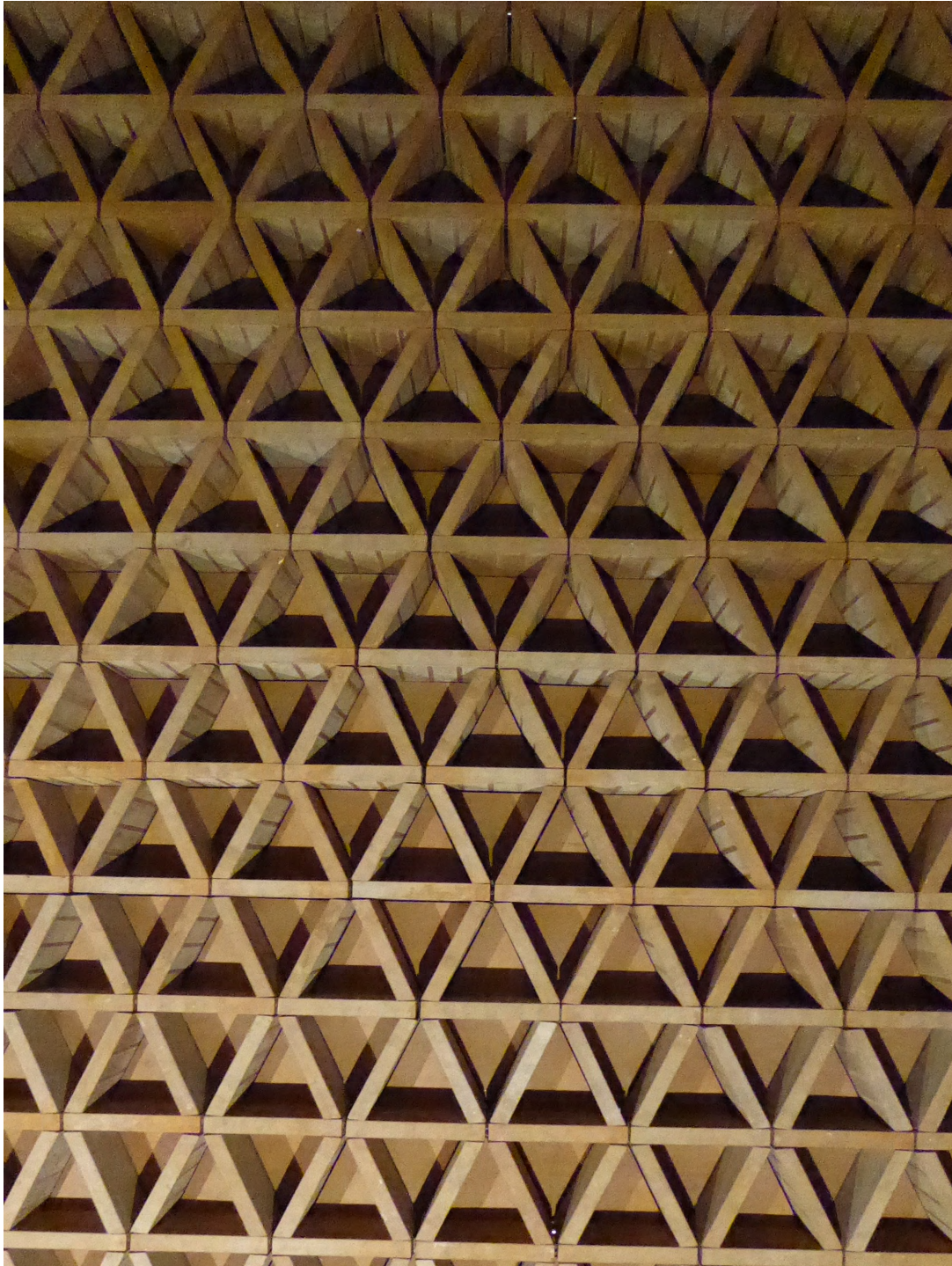







■ DETTAGLIO 2: SEZIONI DELLE VOLTE / DETAIL 2: SECTIONS OF THE VAULTS
CANTINA ANTINORI

